

KC / ACTE XXVII

Kennedy Center American College Theater Festival XXVII



REGION V

JAN. 24-29, 1995

NEBRASKA WESLEYAN

UNIVERSITY

UNIVERSITY OF

NEBRASKA-LINCOLN

**WE WELCOME YOU
TO THE FESTIVAL!**

KC/ACTF REGIONAL OFFICERS

Paul J. Hustoles, Regional Chair
Mankato State University

Dan Plato, Regional
Playwriting Chair
University of North Dakota

Gregg Henry, Regional Vice-Chair
Iowa State University

Clyde Ruffin, Regional
Playwriting Vice-Chair
University of Missouri, Columbia

USITT OFFICERS

Heart of America Section

John Uthoff, Chair
Kansas State University

William J. Nix, Vice-Chair
Programming
Bowlus Fine Arts Center

HOST SCHOOLS

Department of Communication
and Theatre Arts
Nebraska Wesleyan University
David M. Clark, Chair

Department of Theatre Arts
and Dance
University of Nebraska-Lincoln
Tice L. Miller, Chair

FESTIVAL STAFF

Layne Ehlers
Festival Coordinator

Julie Hagemeyer
Assistant Festival Coordinator

Henry H. Blanke, Jr.
Nebraska Wesleyan Coordinator

Richard Schroeder
NWU Technical Coordinator

Harry Traum IV
UNL Technical Coordinator

Timothy Case
Load-In Competition

Tara Eney
Assistant to the Regional Chair

Mark Giesler
Registration

Andrew Hayes
Irene Ryan Competition

Katherine LaPietra
National Team Hospitality

Robin McKercher
Workshops

Patrick Tuttle
Student Hospitality

Robert Welk
Design Competition

REGION V FESTIVAL WHO'S WHO

THE KC/ACTF NATIONAL SCREENING TEAM

Terry Allen
Ron Himes
John Lion
Ginny Quinley

THE REGION V FESTIVAL RESPONDENTS

Alex Chrestopoulos
Harlene Marley
Craig Wolf

THE IRENE RYAN SEMI-FINALS ADJUDICATORS

Robert Buseick
Lauren Friesen
JoAnn Schmidman

THE IRNE RYAN FINALS ADJUDICATORS

David Mark Cohen
Judith Royer

THE DESIGN COMPETITION RESPONDENT

Craig Wolf

NEW PLAY DEVELOPMENT RESPONDENTS

David Mark Cohen
Dan Plato
Clyde Ruffin

NATIONAL CRITICS INSTITUTE CRITIC

Larry Kubert

BURNHAM YATES
 CONFERENCE
 CENTER
 LOWER LEVEL
 CORNHUSKER
 HOTEL

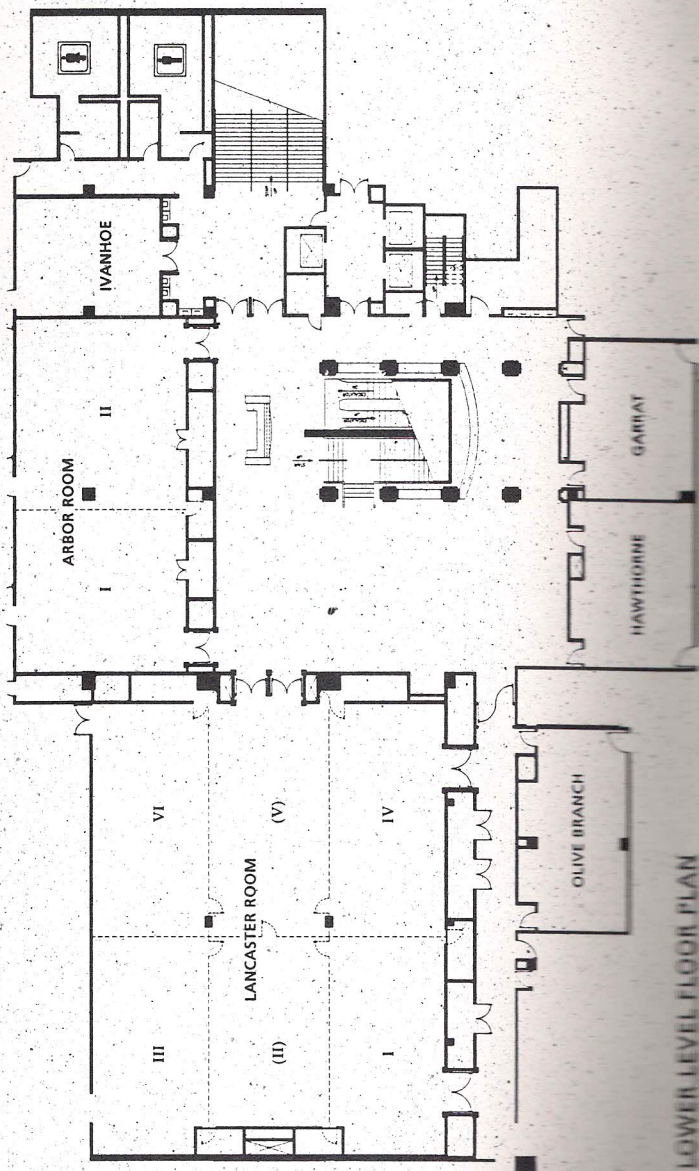

LOWER LEVEL FLOOR PLAN

PARTIAL MAP OF
 UNL
 CITY CAMPUS

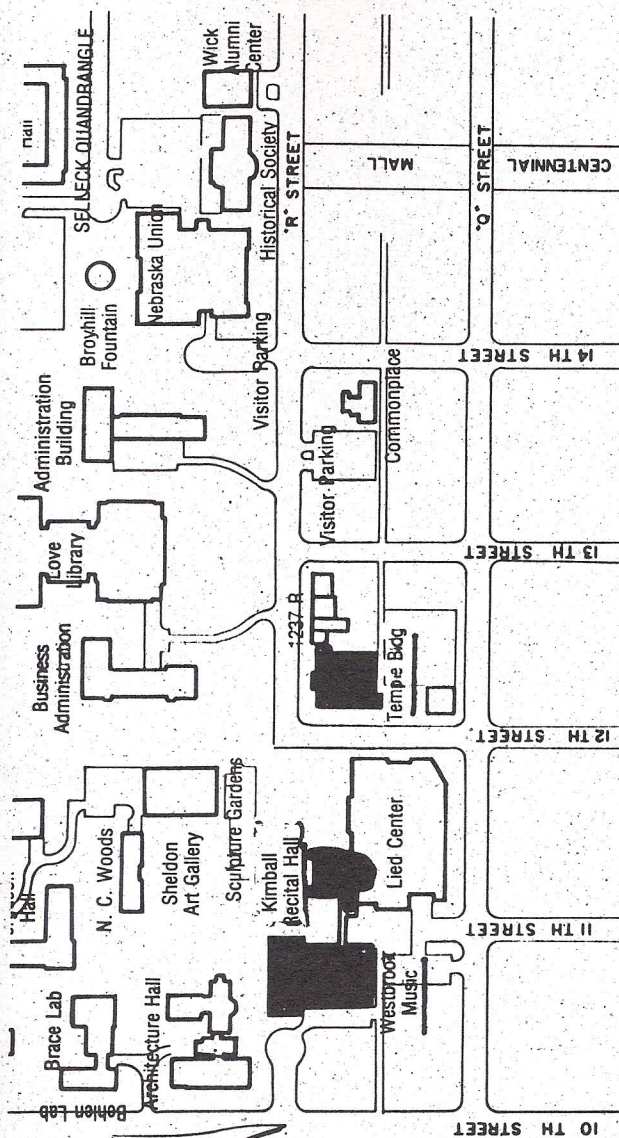

Showing Temple
 Building,
 Westbrook Music
 Hall, and
 Kimball Recital
 Hall

MAP OF DOWNTOWN LINCOLN

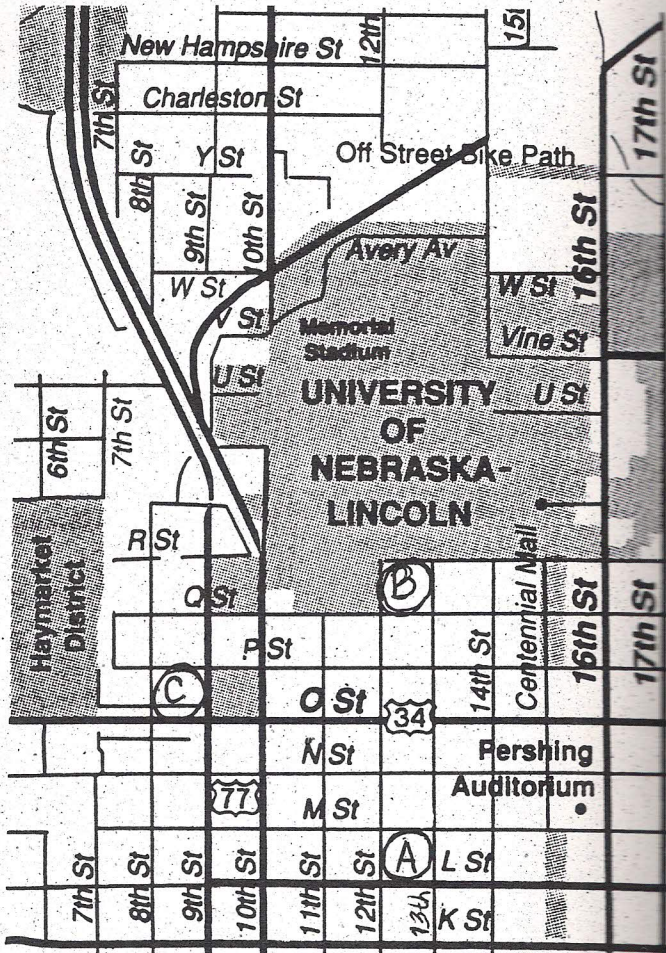

A = Cornhusker
Hotel

B = Temple Bldg.,
UNL

C = Ramada Inn

MAP OF ROUTE FROM CORNHUSKER HOTEL TO NEBRASKA WESLEYAN CAMPUS

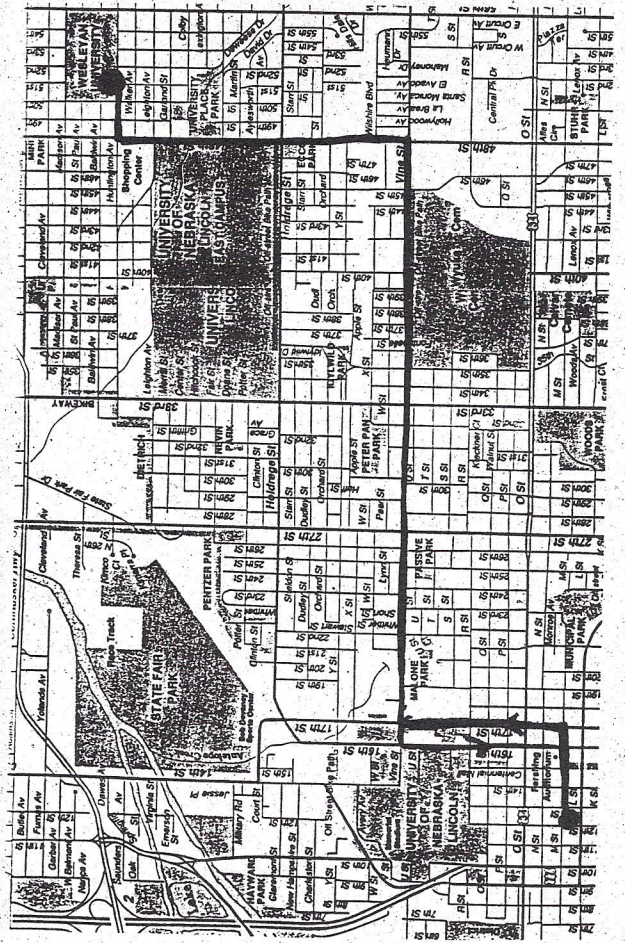

McDonald Theatre
marked with
circle

PROGRAM OF EVENTS

All Festival Events in the Burnham Yates
Conference Center [BYCC], Cornhusker Hotel,
unless indicated

TUESDAY JANUARY 24

2:00 - 5:00 P.M.

BYCC
REGISTRATION/Irene Ryan Check-In
Mark Giesler, Registration Coordinator

6:00 - 7:00 P.M.

Howell Theatre Lobby, Temple Building
REGISTRATION/Irene Ryan Check-In

7:00 - 7:30 P.M.

Howell Theatre
IRENE RYAN GATHERING

7:30 - 10:30 P.M.

Howell Theatre, Westbrook Music Bldg.
IRENE RYAN PRELIMINARIES

11:00 P.M.

Howell Theatre
IRENE RYAN GATHERING
Announcement of Semi-Finalists

11:30 P.M. - 1:00 A.M.

ACTF Faculty Hospitality Suite 818
FACULTY AND FESTIVAL STAFF
EVENING HOSPITALITY
Layne Ehlers, Festival Coordinator

WEDNESDAY JANUARY 25

9:00 A.M. - 4:00 P.M.

BYCC
REGISTRATION

9:00 A.M. - 6:00 P.M.

Arbor 1 Closed Event
DESIGN EXHIBITION SET-UP

Studio Theatre, Temple Closed Event
LIGHTING COMPETITION SET-UP

9:30 A.M. - 12:00 Noon

Kimball Recital Hall
IRENE RYAN SEMIFINALS

1:00 - 3:30 P.M.

Kimball Recital Hall
IRENE RYAN SEMIFINALS

3:30 P.M.

Kimball Recital Hall
IRENE RYAN FINALISTS ANNOUNCED
Drawing for Times

4:00 - 7:30 P.M.

Kimball Recital Hall Closed Event
FINALISTS REHEARSAL

8:00 - 10:00 P.M.

Kimball Recital Hall
IRENE RYAN REGION V ACTING
COMPETITION FINALS

10:30 P.M. - MIDNIGHT

ACTF Hospitality Suite 818
FACULTY AND FESTIVAL STAFF
EVENING HOSPITALITY
Layne Ehlers, Festival Coordinator

THURSDAY JANUARY 26

9:00 A.M. - 4:00 P.M.

BYCC
REGISTRATION

9:00 A.M. - 6:00 P.M.

Arbor I
DESIGN COMPETITION EXHIBITION

Studio Theatre, Temple
LIGHTING DESIGN COMPETITION

Closed Event, except as indicated

Robert Welk, Univ. Nebr-Omaha

David Thayer, Univ. of Iowa

John Uthoff, Kansas State University

Dennis Chandler, Univ. of South Dakota

9:00 - 11:00 A.M.

Howell Theatre
LOAD-IN COMPETITION

Closed Event

The Endless Adventures of M.C. Kat
(Washington University)

Closed Event

Tim Case, Univ. South Dakota

9:00 A.M. - 12:15 P.M.

Lancaster 5,6
THEATRE OF THE OPPRESSED (AN
INTERACTIVE WORKSHOP)

Limit: 40

An exploration of the revolutionary improvisation and performance techniques developed by Augusto Boal, Brazilian theatre practitioner, theorist, and author of *Theatre of the Oppressed* and *Theatre Games for Non-Actors*.

Doug Paterson, U Nebr-Omaha

THURSDAY, JANUARY 26

10:45 A.M. - 12:15 P.M.

CAD Lab, Temple 103
COMPUTER AIDED DESIGN HANDS-ON
WORKSHOP, sponsored by USITT Heart of
America.

Limit: 6

Self-paced tutorials on AutoCad, 3DStudio and PhotoShop. Experienced students and faculty teach the tricks of the trade for drafting and design for film, television, and theatre.

Charles O'Connor, UNL

Yankee Hill 1
CRITICS INSTITUTE

By Registration Only

Larry Kubert, Lincoln Journal

Arbor II
PLAYWRITING WORKSHOP

Limit: 20; By Registration Only

A three-day series of playwriting workshops. Participation limited to first 20 students who pre-register, but observers are welcome. Participants are expected to attend all three morning sessions.

David Mark Cohen, U TX-Austin

Lancaster 1,2,3
VOCAL EXTREMES: SHOUTING AND
SCREAMING FOR THE STAGE & FILM

This hands-on workshop will present a safe and effective approach to performance shouting and screaming, creating the desired dramatic effect of extreme vocal expression without hurting the instrument.

Kate Ufema, Univ Minn-Duluth

Hawthorne
MUSICAL THEATRE DANCE

This workshop emphasizes the impetuosity needed to stage a musical theatre number for the chorus. "Coffee Break" from *How To Succeed In Business Without Really Trying* will be featured. The acting of dance movement will also be addressed.

Lewis Whitlock III, Mankato

Lancaster 4
ACTF ADJUDICATION WORKSHOP

Faculty Only

Would you like to join the intrepid purveyors of theatrical wisdom on the roads of middle America? This session will tell you everything you need to know to become an official adjudicator (either as "Responder" or "Selector") of Region V of KC/ACTF.

Paul J. Hustoles, Region V Chair

THURSDAY, JANUARY 26

10:45 A.M. - 12:15 P.M.

Lied Center Lobby

TECH TOUR OF THE LIED CENTER

Lied Center for Performing Arts
backstage tour.

John Himmelberger, *Lied Center*

12:30 - 1:30 P.M.

McDonald Theatre Lobby

COSTUME LIBRARY TOUR

REPEATS FOLLOWING

MATINEE PERFORMANCE

Featuring more than 30,000 costumes,
this library includes pieces from nearly every
historical period.

Phyllis Blanke, *Nebr Wesleyan U*

1:30 - 2:30 P.M.

Studio Theatre, Temple

**LIGHTING DESIGN COMPETITION PUBLIC
PERFORMANCE**

Robert Welk, *Univ Nebr-Omaha*

David Thayer, *Univ. of Iowa*

John Uthoff, *Kansas State University*

Dennis Chandler, *Univ. of South Dakota*

1:30 P.M.

Howell Theatre

**PERFORMANCE: *The Endless Adventures of
M. C. Kat***

by Jeffrey Jones

KC/ACTF Region V Festival Entry

Washington University

McDonald Theatre

PERFORMANCE: AN EVENT OF ONE-ACTS

Canvass by Sarah Zercher

The Beadsman by Brian Boies

KC/ACTF Region V Festival Entry

English Alternative Theatre, KU

AND

Black Sheep by Bobbi Benson

KC/ACTF Region V Festival Entry

South Dakota State University

THURSDAY, JANUARY 26

4:15 - 5:45 P.M.

CAD Lab, Temple 103

COMPUTER AIDED DESIGN LAB OPEN

HOUSE, sponsored by USITT Heart of America

Self-paced tutorials on AutoCad, 3DStudio
and PhotoShop. Beginners welcome.
Workshops take place in the state-of-the-art
computer lab in the Department of Theatre Arts
and Dance on the UNL campus.

Charles O'Connor, *UNL*

Yankee Hill I

By Registration Only

CRITICS INSTITUTE

Larry Kubert, *Lincoln Journal*

Lancaster 5,6

STAGED READING AND RESPONSE:

STUDENT ORIGINAL SHORT PLAY

Sizing by Nita Ritzke, *U No. Dakota*

Terry Allen, *National Team*

David Mark Cohen, *U TX-Austin*

Dan Plato, *Region V Pwt. Chair*

Clyde Ruffin, *Univ MO-Columbia*

Lancaster 1,2,3

Limit 25

**WHAT CAN I DO TO EARN A LIVING NOW
THAT I HAVE A DEGREE IN ACTING?**

Discussion of employment choices for
BFA/MFA actors beyond the usual acting and/or
teaching possibilities.

Ann Niergarth, *Doane College*

Hawthorne

CAMERA REALITIES

Practical discussion and a hands-on
look at the realities of microphones, cameras,
lights and wardrobe for the camera. Includes
first-hand information about what movie and
commercial directors are looking for, and where
to look for work. Session includes a taped
interview with Tom Boswell, Lincoln native and
Equity actor, about his experiences in finding
work during ten years in *The Business* in New
York City.

Robert Christoffersen, *Impact
Communications, Inc.*

THURSDAY, JANUARY 26

4:15 - 5:45 P.M.

Lancaster 4

THEATRICAL COLLABORATION

A dialogue session on how the Omaha Magic Theatre builds plays collaboratively, their creative process as writers, directors, designers, and technicians, and a look at some of the imagery created by OMT over the past 27 years.

Megan Terry, OMT
JoAnn Schmidman, OMT
Sora Kimberlain, OMT

Arbor II

TOWARDS A BLACK THEATRE

A discussion of the goals of building a black theatre company, using Penumbra Theatre as a model. Includes examples from Langston Hughes' *Black Nativity*, a Penumbra production

Lewis Whitlock III, *Mankato*

6:00 - 7:30 P.M.

Wick Center, UNL

Invitation Only

**UNL COLLEGE OF FINE & PERFORMING
ARTS AND DEPARTMENT OF THEATRE
ARTS & DANCE WELCOME DINNER**

Larry Lusk, Dean of the College
Tice Miller, Chair of the Department

8:00 P.M.

Howell Theatre

**PERFORMANCE: *The Endless Adventures of
M. C. Kat***

by Jeffrey Jones
KC/ACTF Region V Festival Entry
Washington University

McDonald Theatre

PERFORMANCE: AN EVENT OF ONE-ACTS

Canvass by Sarah Zercher
The Beadsman by Brian Boies
KC/ACTF Region V Festival Entry
English Alternative Theatre, KU
AND
Black Sheep by Bobbi Benson
KC/ACTF Region V Festival Entry
South Dakota State University

THURSDAY, JANUARY 26

10:00 P.M. - 1:00 A.M.

Lancaster Ballroom

ALL-FESTIVAL PARTY

Cash Bar. You will be carded:
Patrick Tuttle, Student Hospitality

11:00 P.M.

Lancaster Ballroom

PERFORMANCE: *SOUND FIELDS*

Excerpted scenes from the Omaha Magic Theatre's current touring production. Written, created, and performed by Megan Terry, JoAnn Schmidman and Sora Kimberlain.

Omaha Magic Theatre

POST-PERFORMANCE

Lancaster Ballroom

PARTY CONTINUES

ACTF Festival Hospitality Suite 818

**FACULTY AND FESTIVAL STAFF
EVENING HOSPITALITY**

Layne Ehlers, Festival Coordinator

**FRIDAY
JANUARY 27**

7:30 A.M.

Cornhusker Hotel Cafe

Closed Event

PLAYWRIGHTS BREAKFAST

Bobbi Benson, *Black Sheep*; Brian Boies,
The Beadsman; and Sarah Zercher, *Canvass*.
Terry Allen, National Team

Cornhusker Hotel Cafe

Closed Event

DIRECTORS BREAKFAST

Charles Cranston, *Black Sheep*; Melanie
Dreyer, *The Endless Adventures of M.C. Kat*;
and Lance Gharavi, *Canvass* and *The
Beadsman*.

Paul J. Hustoles, Region V Chair

FRIDAY, JANUARY 27

8:30 A.M. - 9:00 A.M.

Lancaster 5,6

LOAD-IN COMPETITION RESPONSE

The Endless Adventures of M.C. Kat
[Washington University].

Tim Case, Univ. South Dakota

9:00 A.M. - 4:00 P.M.

BYCC

REGISTRATION

9:00 A.M. - 6:00 P.M.

Arbor I

DESIGN EXHIBITION

9:00 A.M. - 2:30 P.M.

Studio Theatre, Temple

LIGHTING DESIGN COMPETITION

Closed event except as indicated.

Robert Welk, Univ. Nebr-Omaha

David Thayer, Univ. of Iowa

John Uthoff, Kansas State University

Dennis Chandler, Univ. of South Dakota

9:00 A.M. - 10:30 A.M.

Lancaster 5,6

ALL-FESTIVAL RESPONSE SESSION 1

Response by Region V Festival Respondents to *Canvass* [English Alternative Theatre, KU], *The Beadsman* [English Alternative Theatre, KU], *Black Sheep* [University of South Dakota], and *The Endless Adventures of M.C. Kat* [Washington University].

Alex Chrestopoulos, SIU-Carbondale

Harlene Marley, Kenyon College

R. Craig Wolf, San Diego State U

FRIDAY, JANUARY 27

9:00 - 11:00 A.M.

Howell Theatre

Closed Event

LOAD-IN COMPETITION

Brilliant Traces [Fontbonne College].

Tim Case, Univ. South Dakota

McDonald Theatre

Closed Event

LOAD-IN COMPETITION

Tartuffe [University of Kansas]

Tim Case, Univ. South Dakota

10:30 A.M. - 1:00 P.M.

Arbor I

Closed Event

DESIGN EXHIBITION CLOSED FOR ADJUDICATION

10:45 A.M. - 12:15 P.M.

CAD Lab, Temple 103

COMPUTER AIDED DESIGN LAB OPEN

HOUSE, sponsored by USITT Heart of America

Self-paced tutorials on AutoCad, 3DStudio and PhotoShop. Beginners welcome. Workshops take place in the state-of-the-art computer lab in the Department of Theatre Arts and Dance on the UNL campus.

Charles O'Connor, UNL

Lancaster 5,6

COSTUMERS NETWORK, sponsored by USITT Heart of America

All Costume Designers and Technologists are invited to establish a plan to improve Costuming Networking and Programming in the Region V area of KC/ACTF. Please come and help develop a method to improve interaction in this vital field.

Dana Pinkston, Kansas State U

Yankee Hill I

By Registration Only

CRITICS INSTITUTE

Larry Kubert, Lincoln Journal

FRIDAY, JANUARY 27

10:45 A.M. - 12:15 P.M.

Arbor II Limit 20; By Registration Only
PLAYWRITING WORKSHOP

A three-day series of playwriting workshops. Participation limited to first 20 students who pre-register, but observers are welcome. Participants are expected to attend all three morning sessions.

David Mark Cohen, *UTX-Austin*

Lancaster 1,2,3

OUT: DEVELOPMENT OF A NEW PLAY

Selected scenes from and discussion of the new play development process used for *Out*, an Associate Entry from the University of Iowa.

Carol MacVey, Director, *Out*

Hawthorne

CAMERA REALITIES

Practical discussion and a hands-on look at the realities of microphones, cameras, lights and wardrobe for the camera. Includes first-hand information about what movie and commercial directors are looking for, and where to look for work. Session includes a taped interview with Tom Boswell, Lincoln native and Equity actor, about his experiences in finding work during ten years in *The Business* in New York City.

Robert Christoffersen, *Impact Communications, Inc.*

Lancaster 4

**ALTERNATE CAREERS IN TECH THEATRE;
OR, "SO WHAT DO YOU DO WITH A TECH
THEATRE DEGREE, ANYWAY?"**

A panel discussion by several persons whose career paths have taken them away from what we think of as theatre tech. They will offer some suggestions on job opportunities that may exist outside of traditional theatre production.

MODERATOR: William Nix
Bowlus Fine Arts Center

Lied Center Lobby

TECH TOUR OF THE LIED CENTER

Lied Center for Performing Arts backstage tour.

John Himmelberger, *Lied Center*

FRIDAY, JANUARY 27

12:30 - 1:30 P.M.

McDonald Theatre Lobby

COSTUME LIBRARY TOUR

**REPEATS FOLLOWING MATINEE
PERFORMANCE**

Featuring more than 30,000 costumes, this library includes pieces from nearly every historical period.

Phyllis Blanke, *Nebraska Wesleyan U*

1:30 - 2:30 P.M.

Studio Theatre, Temple

**LIGHTING DESIGN COMPETITION PUBLIC
PERFORMANCE**

Robert Welk, *Univ Nebraska-Omaha*

1:30 P.M.

Howell Theatre

PERFORMANCE: *Brilliant Traces*

by Cindy Lou Johnson

KC/ACTF Region V Festival Entry
Fontbonne College

McDonald Theatre

PERFORMANCE: *Tartuffe*

by Moliere, adapt. by Richard Wilbur

KC/ACTF Region V Festival Entry
University of Kansas

2:30 - 3:30 P.M.

Temple 221

**LIGHTING DESIGN COMPETITION
RESPONSE AND ADJUDICATION**

Robert Welk, *Univ. Nebr-Omaha*

David Thayer, *Univ. of Iowa*

John Uthoff, *Kansas State University*

Dennis Chandler, *Univ. of South Dakota*

2:30 P.M.

Studio Theatre, Temple

LOAD-IN, *Flow My Tears, the Policeman Said*

FRIDAY, JANUARY 27

4:00 - 6:30 P.M.

Lancaster 5,6

**STAGED READING AND RESPONSE:
STUDENT ORIGINAL FULL LENGTH PLAY**

Nightmare, Fairytales, and

Commitment by Ryan Ritter, K State

Terry Allen, National Team

David Mark Cohen, U TX-Austin

Dan Plato, Region V Pwt. Chair

Clyde Ruffin, U MO-Columbia

4:15 - 5:45 P.M.

CAD Lab, Temple 103

**COMPUTER AIDED DESIGN LAB OPEN
HOUSE, sponsored by USITT Heart of America**

Self-paced tutorials on AutoCad, 3DStudio, and PhotoShop. Beginners welcome. Workshops take place in the state-of-the-art computer lab in the Department of Theatre Arts and Dance on the UNL campus.

CHARLES O'CONNOR, UNL

Temple 205

**CAREERS IN ART DIRECTION AND
PRODUCTION DESIGN FOR FILM AND
TELEVISION, sponsored by USITT Heart of
America**

Overview of what it is like and what it takes to design for the movies and television.

Sandy Veneziano, Art Director

Dead Poets Society, Home Alone 2

Yankee Hill I

CRITICS INSTITUTE

By Registration Only

Larry Kubert, *Lincoln Journal*

Hawthorne

**THE ONE-PERSON SHOW: AN ACTOR'S
PATH TO SELF-EMPLOYMENT**

The first part of the workshop will cover the numerous performance opportunities available to the actor in the genre of one-person show. Three basic types of shows will be discussed: historical, dramatic or theatrical, and performance art. The rest of the workshop will be concerned with the various aspects of putting a one-person show together, from getting started with an idea to marketing and managing the production.

Mark A. Klemetsrud, UNL

FRIDAY, JANUARY 27

4:15 - 5:45 P.M.

Lancaster 1,2,3

UNARMED STAGE COMBAT

Limit: 30

Hands-on workshop exploring basic techniques and safety measures for realistic unarmed stage combat. Participants should wear comfortable clothing and come prepared for movement.

Paul Steger, UNL

6:00 - 7:30 P.M.

Art Gallery, NWU

**NEBRASKA WESLEYAN UNIVERSITY AND
DEPARTMENT OF COMMUNICATION AND
THEATRE ARTS WELCOME DINNER**

Invitation Only

John White, University President

David M. Clark, Department Chair

8:00 P.M.

Howell Theatre

PERFORMANCE: *Brilliant Traces*

by Cindy Lou Johnson

KC/ACTF Region V Festival Entry

Fontbonne College

McDonald Theatre

PERFORMANCE: *Tartuffe*

by Moliere, adapt. by Richard Wilbur

KC/ACTF Region V Festival Entry

University of Kansas

10:00 P.M. - MIDNIGHT

Lancaster Ballroom

ALL-FESTIVAL PARTY

Cash Bar. You will be carded.

Patrick Tuttle, Student Hospitality

11:00 P.M. - MIDNIGHT

ACTF Festival Hospitality Suite 818

**FACULTY AND FESTIVAL STAFF EVENING
HOSPITALITY**

Layne Ehlers, Festival Coordinator

FRIDAY, JANUARY 27

MIDNIGHT

Lancaster Ballroom

**PERFORMANCE: "THE MOTHERS"
IMPROV TROUPE**

Cash bar. You will be carded.

Patrick Tuttle, *Mothers Improv Troupe*

SATURDAY JANUARY 28

7:30 A.M.

Cornhusker Cafe

Closed Event

DIRECTORS BREAKFAST

Carlyn Cahill, *Brilliant Traces*, and
Ron Popenhagen, *Tartuffe*.

Paul J. Hustoles, Region V Chair

8:00 - 9:30 A.M.

Yankee Hill I

By Registration Only

CRITICS INSTITUTE

Larry Kubert, *Lincoln Journal*

8:30 A.M. - 9:00 A.M.

Lancaster 5,6

LOAD-IN COMPETITION RESPONSE

Brilliant Traces [Fontbonne College]
and *Tartuffe* [University of Kansas].

Tim Case, *Univ. South Dakota*

9:00 A.M. - NOON

BYCC

REGISTRATION

9:00 A.M. - 6:00 P.M.

Arbor I

DESIGN EXHIBITION

SATURDAY, JANUARY 28

9:00 - 10:30 A.M.

Lancaster 5,6

ALL-FESTIVAL RESPONSE SESSION 2

Response by Region V Festival
Respondents to *Brilliant Traces* [Fontbonne
College] and *Tartuffe* [University of Kansas].

Alex Chrestopoulos, *SIU-Carbondale*

Harlene Marley, *Kenyon College*

R. Craig Wolf, *San Diego State U*

9:00 - 11:00 A.M.

McDonald Theatre

Closed Event

LOAD-IN COMPETITION

The Red House [Southwest Missouri State]

Tim Case, *Univ. South Dakota*

10:00 A.M.

Studio Theatre, Temple

**PERFORMANCE: *Flow My Tears, The
Policeman Said***

by Phillip Dick, adapt. Linda Hartnian

KC/ACTF Region V Festival Entry

Doane College

10:45 A.M. - 12:15 P.M.

CAD Lab, Temple

Limit: 6

**COMPUTER AIDED DESIGN HANDS-ON
WORKSHOP, sponsored by USITT Heart of
America**

Self-paced tutorials on AutoCad, 3D
Studio and PhotoShop. Experienced students and
faculty teach the tricks of the trade for drafting
and design for film, television, and theatre.

Charles O'Connor, *UNL*

Hawthorne

**ARE TECHNICAL DIRECTORS BORN OR
MADE?, sponsored by USITT Heart of America**

This seminar looks at the relationship
between artistic and technical thought processes.
Do technicians really think differently? What
should define a Technical Director's job? Join
us in a look at how Technical Directors think
and how they are perceived!

William C. Fox, Technical Director
Century II Arts & Convention Center

SATURDAY, JANUARY 28

10:45 A.M. - 12:15 P.M.

Temple 205

COSTUME RENDERING FOR THE STUDENT,
sponsored by USITT Heart of America

A discussion of the unique costume rendering program at the University of Missouri-Kansas City and techniques to facilitate costume rendering for the student.

Victoria Marshall, *UMKC*

Arbor II Limit 20; By Registration Only
PLAYWRITING WORKSHOP

A three-day series of playwriting workshops. Participation limited to first 20 students who pre-register, but observers are welcome. Participants are expected to attend all three morning sessions.

David Mark Cohen *U TX-Austin*

Arbor I
**DESIGN EXHIBITION COMPETITION
CRITIQUE**

R. Craig Wolf, *San Diego State Univ.*

Lancaster 5,6
**STAGED READING: "BLUE SKIES" FROM
PLATTE VALLEY TRILOGY**

Text by Lauren Friesen, *Goshen College*

Directed by Randall Wheatley, *UNL*

Open Response by the Playwright

Lancaster 1,2,3
SHAKESPEARE SCANSION SIMPLIFIED

Hands-on look at understanding and unlocking Shakespearean verse for actors and directors.

Shirley Carr Mason, *UNL*

12:30 - 1:30 P.M.

McDonald Theatre Lobby
**COSTUME LIBRARY TOUR
REPEATS FOLLOWING MATINEE
PERFORMANCE**

Featuring more than 30,000 costumes, this library includes pieces from nearly every historical period.

Phyllis Blanke *Nebraska Wesleyan U*

Temple 224
**USITT HEART OF AMERICA BUSINESS
MEETING**

John Uthoff, Section Chair

SATURDAY, JANUARY 28

1:30 P.M.

McDonald Theatre

PERFORMANCE: *The Red House*

Book, Music and Lyrics by Brett

Kristofferson

KC/ACTF Region V Festival Entry

Southwest Missouri State University

Howell Theatre

**PERFORMANCE: *Flow My Tears, The
Policeman Said***

by Phillip Dick, adapt. Linda Hartnian

KC/ACTF Region V Festival Entry

Doane College

2:45 - 5:45 P.M.

Scene Shop, Temple

**SCENE PAINTING REALISTIC TEXTURES
AND DISTRESSING TECHNIQUES; sponsored
by USITT Heart of America**

Techniques in faux finishes and realistic textures such as wood grain, marble, and stone. Aging techniques, such as blocking and using sodium silicate.

Robin McKercher, *UNL*

4:00 P.M.

Howell Theatre

**PERFORMANCE: *Flow My Tears, The
Policeman Said***

by Phillip Dick, adapt. Linda Hartnian

KC/ACTF Region V Festival Entry

Doane College

4:15 - 5:45 P.M.

CAD Lab, Temple

**COMPUTER AIDED DESIGN LAB OPEN
HOUSE, sponsored by USITT Heart of America**

Self-paced tutorials on AutoCad, 3D Studio, and PhotoShop. Beginners welcome. Workshops take place in the state-of-the-art computer lab in the Department of Theatre Arts and Dance on the UNL campus.

Charles O'Connor, *UNL*

SATURDAY, JANUARY 28

4:15 - 5:45 P.M.

Lancaster 5,6

FESTIVENTION OF NEW WORKS

Staged readings from a selection of original plays both produced and unproduced within the region. An opportunity for you to sample new works available for production.

Mike Solomonson, *UNL*, Director
Dan Plato, Region V. Playwriting Chair
Clyde Ruffin, *Univ Missouri-Columbia*

Hawthorne

COLD READINGS: "WHAT THE HECK ARE THEY LOOKING FOR?"

A hands-on look at cold reading approaches.

Ginny Quinley, National Selection Team

Arbor II

Limit: 20

ONE SINGULAR SENSATION: A PRACTICAL WORKSHOP FOR ONE-PERSON PERFORMANCES

The ABCs of putting together a one-person show and taking it on the road.

Jay Scott Chipman, *Nebr Wesleyan Univ*

Lancaster 4

Faculty Only

KC/ACTF REGION V BUSINESS SESSION

Your business is our business. Region V Chair Hustoles invites you to become aware of any and all aspects of KC/ACTF Region V business and procedures, including play selection and festival construction. We need to come up with a better method of doing things and we are open to all suggestions. This region is what we make it; come and help us make it better!

Paul J. Hustoles, Region V Chair

5:00 - 6:30 P.M.

Yankee Hill I

By Registration Only

CRITICS COMPETITION

Larry Kubert, *Lincoln Journal*

6:00 - 7:00 P.M.

Arbor I

Closed Event

DESIGN EXHIBITION TEAR-DOWN

SATURDAY, JANUARY 28

6:00 - 7:30 P.M.

Cornhusker Hotel

Invitation Only

FINAL NIGHT FEAST, REGION V WHO'S WHO

Paul J. Hustoles, Region V Chair
Layne Ehlers, Festival Coordinator

8:00 P.M.

McDonald Theatre

PERFORMANCE: *The Red House*

Book, Music and Lyrics by Brett

Kristofferson

KC/ACTF Region V Festival Entry

Southwest Missouri State University

Howell Theatre

PERFORMANCE: *Flow My Tears, The Policeman Said*

by Phillip Dick, adapt. Linda Hartnian

KC/ACTF Region V Festival Entry

Doane College

SATURDAY, JANUARY 28

10:00 P.M. - 1:00 A.M.

Lancaster Ballroom

ALL-FESTIVAL PARTY

Cash Bar. You will be carded.

Patrick Tuttle, Student Hospitality

11:00 P.M.

Lancaster Ballroom

ANNOUNCEMENT OF AWARDS AND PRESENTATION OF SPECIAL HONORS

Paul J. Hustoles, Region V Chair

POST-AWARDS

ACTF Festival Hospitality Suite 818

FACULTY AND FESTIVAL STAFF EVENING HOSPITALITY

Layne Ehlers, Festival Coordinator

SUNDAY JANUARY 29

7:30 A.M.

Cornhusker Hotel Cafe Closed Event
PLAYWRIGHTS BREAKFAST

Discussion of *The Red House* with Brett Kristofferson, book, music, lyrics.
Terry Allen, National Team

Cornhusker Hotel Cafe Closed Event
DIRECTORS BREAKFAST

Jack Parkhurst, *The Red House*, and Tom Woldt, *Flow My Tears, the Policeman Said*.
Paul J. Hustoles, Region V Chair

8:30 A.M. - 9:00 A.M.

Lancaster 5,6
LOAD-IN COMPETITION RESPONSE

Flow My Tears, the Policeman Said [Doane College] and *The Red House* [Southwest Missouri State University].
Tim Case, Univ. South Dakota

9:00 - 10:30 A.M.

Lancaster 5,6
ALL-FESTIVAL RESPONSE SESSION 3

Response by Region V Festival Respondents to *Flow My Tears, the Policeman Said* [Doane College] and *The Red House* [Southwest Missouri State University].
Alex Chrestopoulos, SIU Carbondale
Harlene Marley, Kenyon College
R. Craig Wolf, San Diego State U

Lincoln Room Invitation Only
FESTIVAL STAFF THANK-YOU BRUNCH

Layne Ehlers, Festival Coordinator
Paul J. Hustoles, Region V Chair

THE 1995 NATIONAL TEAM

TERRY ALLEN, Professor of Theatre Arts and Director of Theatre at the University of Wisconsin-Eau Claire, teaches playwriting, directing, acting, and stage movement. In addition to his many acting and directing credits, he has written numerous works for the stage that have been performed by such organizations as the Westbeth Theatre Center in New York City. Dr. Allen holds an M.A. degree from Central Missouri State University and a Ph.D. from Southern Illinois University at Carbondale. Recently he served as Playwriting Chair for Region III, KC/ACTF.

Dr. Allen is particularly interested in international theatre. He has taught at King Alfred's College in Winchester, England, and served for three years as Director of Fine Arts at Jakarta International School in Indonesia.

RON HIMES, producing director of the St. Louis Black Repertory Company, founded his company in 1976 while a business student at Washington University in St. Louis. In 1992 the company moved into the newly renovated Grandel Square Theatre in the heart of Grand Center, St. Louis' arts and entertainment district, where it experienced record growth in production values, subscriptions, attendance, and contributed support. Himes has produced more than 100 productions at the St. Louis Black Repertory.

His best-known roles include Malcolm X in *The Meeting*, Boesman in *Boesman and Lena*, and Harold Loomis in *Joe Turner's Come and Gone*. His directing credits outside the Black Rep include Theatre Project Company; Studio Theatre in Washington DC; Perseverance Theatre in Juneau, Alaska; and the Old Creamery Theatre in Garrison, Iowa.

Himes has received numerous honors and awards including the Dr. Martin Luther King Jr. Life and Legacy Award from the National Pan-Hellenic Alumni Council, 1993; Conference on

Education's Visions in Education Award, 1993; "Ronald J. Himes Day" from the Mayor's Office, City of St. Louis, 1991; the first Black Alumni Award from the Black Alumni Council at Washington University, 1986; and the 1994 Missouri Arts Award presented by the Missouri Arts Council.

JOHN LION, in his first year of service as Director of the Kennedy Center/American College Theater Festival and Youth and Family Programs, attended the University of Chicago, Berkeley, and Stanford University, where he is ABD. Lion was the founder, General Director, and Artistic Director of The Magic Theatre in San Francisco from 1967 to 1990, where he directed over 70 of the 200 plays produced. In 1979, he produced Sam Shepard's *Buried Child*, which won the Pulitzer Prize and an Obie Award.

Lion has been involved in theatre for more than 23 years. He served on the Rockefeller Foundation Playwright's Award Committee from 1983 to 1989 and received the 1986 Margo Jones Award for "Significant Contributions to the Dramatic Art Through the Production of New Plays."

GINNY QUINLEY, the KC/ACTF National Committee representative, begins her 12th year at Columbia Basin College, where she teaches directing, auditioning, new script development, and children's theatre classes. She is the drama director for Visions and Voices Teen Theatre, a professional touring youth group, now in its fourth season, that addresses issues and problems which affect today's youth.

Quinley also directs videos for industrial and educational use, and two for television, most recently completing an AIDS video for middle schools that will serve as a pilot program in Washington State. Quinley acts and directs for the local semi-professional dinner theatre groups and is active in the community as a talent agent for local commercials and video projects. She received her Bachelors in Speech, Theatre and Education, and her Masters in Theatre, at Washington State University. Chair of Region VII of the Kennedy Center/American College Theater Festival, Quinley currently serves as Chair of the Regional Chairs Committee.

KC/ACTF XXVII

Kennedy Center American College Theater Festival XXVII

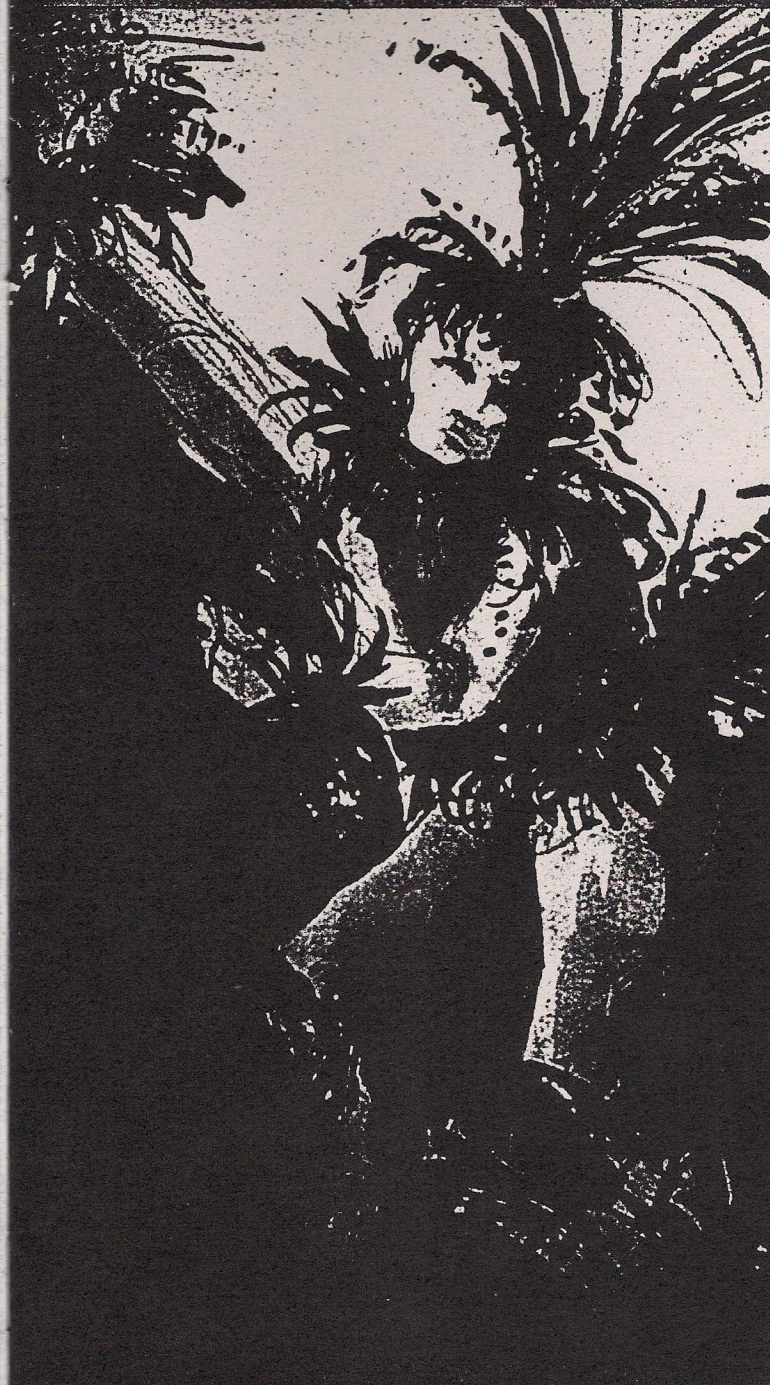

The Kennedy Center

REGION V

Fontbonne Theatre proudly presents

BRILLIANT TRACES

by Cindy Lou Johnson

Director Carlyn Cahill
Stage Manager Carol Ann Thompson
Lighting Designer Michael Sullivan
based on an original design by Sheila Stephens
Sound Designer Steven Cook
Costume Coordinator Annie Warner

Individuation

--Avah Pevlor Johnson--

If I must be wrung through the paradox,
--broken into wholeness,
wring me around the moon;
pelt me with particles from the dark
side.

Fling me into space;
hide me in a black hole.

Let me dance with devils on dead stars.
Let my scars leave brilliant traces,

for my highborn soul seeks its hell
in high places.

CAST OF CHARACTERS

Henry Harry John R. Fischer
Rosannah DeLuce Natalie Schott

*Produced by special arrangement with
Dramatists Play Service*

PRODUCTION STAFF

Props Coordinator Phyllis Butler
Head Carpenter Steve Parhomski
Program Aimee Libke

ACKNOWLEDGEMENTS

Jefferson College
Jim Brouk

Laesch Dairy
Mark Wilson

SOUND ACKNOWLEDGEMENTS

George Winston, Windam Hill,
Patrick Doyle, Epic,
Vangelis, Atlantic and Polydor,
Michael Whalen, Narada,
Marvin Hamlisch/David Zippel, Curb,
Nakai, Canyon,
Frank Patterson, Rego/Shillelagh,
Special Music Company

FRIENDS OF FONTBONNE THEATRE

Angels

A.F. Sullivan, Inc.
Crestwood-Sunset Hills Kiwanis Club

Supporters

Sverdrup Corporation
Mr. and Mrs. Charles Brouk
DeSoto Rotary Club

Washington University
Performing Arts Department presents

THE ENDLESS ADVENTURES OF M.C. KAT; OR, HOW THEY GOT FROM A TO B

by Jeffrey Jones

Directed by Melanie Dreyer

CAST OF CHARACTERS

Tex	Julie Newman
Monica Scott, M.D.	Holly Amantangelo
M.C. Kat	Pamela Sloane
Richard Sorehead	Ryan Patterson
Bob Howard	Alexander Gish
Gary Cohen	Joshua Stein
Bad Tex	Caren Schmulen
Og Oogleby	Maria Aladren
Citizens of the Middle of Nowhere	Corey Jones
The Lonesome Poke	Deena Lynn Rubinson
Understudy	Doug Divine

PRODUCTION STAFF

Stage Manager and Assistant Director	Heather May
Set Designer	Jonathan Goldner
Resident Set Designer	Bruce Bergner
Costume Designer	Jason Carney
Resident Costume Designer	Bonnie Kruger
Lighting Designer	Sybil Wickersheimer
Resident Lighting Designer	Rick Kuykendall
Sound Designer	Adam Simon
Props Master	Leontine Greenberg
Technical Director & Scene Shop Foreman	Richard Wittlief II
Asst Stage Manager	Kristin Abhalter
Lighting Operator	Pete Blumenthal
Sound Operator	Jordana Adelman
Wardrobe	Michelle Ernst
Stage Crew	Russell Chambliss Gretchen Smith
Graphics Assistant	Marion Oberle
Illustrations	Deena Lynn Rubinson

Scene Shop Carpenters and Painters

Sandy Bayne, Tyler Bertram, Robbie Biagi, Wayne Boyce, Jim Break, Colin Brix, Susie Brown, Kelley Couvillion, Alexander Gish, Leontine Greenberg, S. Russel Hall, Sasha Isaac-Young, Corey Jones, Michelle Kinman, Luke McHenry, Alex Menocal, Matt Nieman, J. Petersohn, Laura Satkamp, Dave Spinella, Seth Taylor, Dan Wabyick, Emily Wells

SPECIAL THANKS

Athlete's Foot at the Galleria, Bruce Bergner, Bopp Chapel, Jeffrey Dreyer, Bonnie Kruger, Rick Kuykendall, Matthew Maguire, Barbara Manzara, Jeffrey Matthews, Jim Nicholson, Marion Oberle, Anna Pileggi, Emily Saffer, Southwestern Bell Mobile Systems, Kelly Walker.

DIRECTOR'S NOTES

For several years I have been interested in exploring alternatives to standard realism in theatrical performance. This quest has become an area of intense research and a bit of an artistic obsession. I've read a number of plays by Jeffrey Jones, Mac Wellman, Matthew Maguire, and other contemporary playwrights. I've perused numerous articles and reviews including a brilliant piece by Mac Wellman entitled, "The Theatre of Good Intentions," which opened my mind to numerous possibilities. All of this intellectual exploration was stimulating but ultimately lacked the true test of its viability--performance. *M.C. Kat* has given me the first opportunity to put my research into practice.

This particular script is representative of a trend in contemporary playwriting, coined by the playwright as "collage theatre." Collage Theatre is the result of a process in which the playwright presents a series of seemingly disparate images, creating a visual/aural/kinesthetic tension which then falls upon the viewer to resolve. There is no attempt to honor the standard narrative, thematic, or character-based notions of the well-made play, nor is there an attempt to work against them. The images stand on their own.

In working on this piece, I have been pleased and surprised at how quickly the students took to the process. Setting aside the need to motivate and explain everything gave us a tremendous freedom. We focused primarily on honoring the compartmentalized images and allowing resonances between them to arise naturally. It has been rewarding to see my research come to life. I would love to talk with you about the results.

--Melanie Dreyer

AN EVENT OF ONE-ACTS

CANVASS
by
Sarah Zercher

THE
BEADSMAN
by
Brian Boies

BLACK SHEEP
by
Bobbi Bensen

The English Alternative Theatre
of the English Department,
University of Kansas, presents
two one-act plays:

CANVASS

by Sarah Zercher

and

THE BEADSMAN

by Brian Boies

CANVASS, CAST OF CHARACTERS

June Simon, the Supervisor	Caran Snitz
Jacob Lake, the Employee	Douglas Dezzani

*How much are you willing to pay for a
cleaner Environment? For Art? For
Sex?*

THE SCENE

Early morning and late afternoon at an
Environmental Organization Office in
the midwest. Summer, the present.

15 Minute Intermission

THE BEADSMAN, CAST OF CHARACTERS

Pasty Lyman, the Beadsman	Brian Paulette
Mauro Fosche, a TV Producer	Eric C. Leonard
Joe Petefish, a Young Man	Jeremy Wilhm
Sue Angino, a Journalist	Linda Graziano
Mark Capps, Another Young Man	Jeremy Auman

*"The Beadsman, after thousands aves
told,
For aye unsought for slept among his
ashes cold."*

--John Keats,
"The Eve of St. Agnes"

THE SCENE

A one-room apartment in the East
Village, New York City. Early fall, the
present.

PRODUCTION STAFF

Director	Lance Gharavi
Stage Manager	Steve Bryce-Holtzman
Sets and Costumes	Kaye Miller
Lights & Sound	Cynthia Wimmer
Props & Graphics	Paul Stephen Lim
EAT Artistic Director	Paul Stephen Lim
EAT Technical Director	Kaye Miller

MANY THANKS TO

Sam Chapman, Grant K. Goodman, Jim
Rupperecht, Andrew Rymill, Linda
Smith.

DIRECTOR'S NOTES

The English Alternative Theatre
was founded by Paul Stephen Lim in
October of 1990, shortly after the English
Department at the University of Kansas
began to offer playwriting courses in its
Creative Writing program. To date, EAT
has mounted 18 productions and 37
staged readings of plays. Of the 55
playwrights we have showcased thus
far, 23 have been KU students.

ABOUT THE PLAYWRIGHTS

SARAH ZERCHER is a 1994 graduate of the University of Kansas, where she majored in English. Her first play, *Canvass* is based on her experiences working as a canvasser in Ohio. Ms. Zercher currently resides in Oklahoma City where she is at work on a new play.

BRIAN BOIES was born in Cincinnati and raised in Illinois and Oklahoma. He received his BA in English at the University of Kansas last May. Brian is on academic hiatus at the moment, but hopes to go to library school eventually. *The Beadsman* is his second play.

The Beer and Cheerios
Playwriting Society
of the University of South Dakota
presents

BLACK SHEEP

by Bobbi Benson

Directed by Charles Cranston

CAST OF CHARACTERS

Mindy Wright
Tom Suthers
June Wright
Roland Wright
Katherine Wright
Wess Wright
Daisy Wright
Jerry Wright
Sunny Wright

Karen Evans
Doug Roegiers
Jennifer Novacek
Bruce Chandler
Traci Kern
Brian Moss
Anna Ristic
Jim Olson
Madeline Moore

PRODUCTION STAFF

Asst Director & Stage Manager Kay Hall

SCENE

The home of June and Roland Wright

DIRECTOR'S NOTES

The question has been asked numerous times: where did the name, "The Beer and Cheerios Playwriting Society," originate? The answer is an easy one: the name came from a student-written play, of course! Several years ago, the USD Theatre produced *The Marriage Protection Agency* by Dwight Markus, one of the most prolific writers to come out of USD. In his one-act comedy, the central character comes home to find his wife eating a bowl of cereal in front of the television; his opening line of dialogue is, "Beer and Cheerios. You must be pissed!" In recognition of Dwight's many years of devotion to the writing of new and experimental works for the stage, the Society took its name.

The history of playwriting at the University of South Dakota parallels that of the development of the Department of Theatre: "Doc" Lee's first love was writing for the stage; Wayne Knutson is among the very best playwrights this state has produced; student writers like Jeff Pate, Craig Volk, and Doug Steckler continue to find a home at USD. An impressive number of student playwrights are enrolled at the University, all of whom are presently involved in the writing of new and experimental works for the stage. To encourage their continued development is the primary goal of the Beer and Cheerios Playwriting Society.

Future projects for the Society include new play readings, workshops, and more world premieres by South Dakota playwrights.

ABOUT THE PLAYWRIGHT

Bobbi Benson, a graduate of Winner High School, is entering her senior year at USD where she is an English major with a criminal justice minor. *Black Sheep* is her first play.

Doane Theatre presents

FLOW MY TEARS, THE POLICEMAN SAID

based on the novel by Phillip K. Dick
Dramatized by Linda Hartinian

CAST OF CHARACTERS

TV Stage Manager/Receptionist/ Peggy/Pol/Waitress	Robyn Phillips
Jason Taverner	Brett Sheridan
Heather Hart	Carrie Zochol
Background Singer/ Mary Ann Dominic	Tica Felise Perri
Background Singer/Marilyn Mason/Waitress	Christine R. Bolles
Herb Maime (Narrator)	Jason Weible
TV Engineer/Eddie/ Waiter/Pol	Ryan P. McArdle
Al Bliss/Insp. McNulty	James Kyhn
Guard/Waiter/Pol	Nate Huber
TV Camera Operator/ Waitress	Penny Mulligan
Kathy Nelson	Libby Power
Felix Buckman	Patrick Stone
Alys Buckman	Dawna Gantvoort
Ruth Rae	Stephanie A. Quandt
Barney Buckman	Austin R. Mouw

There will be a 10 minute intermission

Time: The Future
Place: Los Angeles and Las Vegas

Produced by Special Arrangement with
The Dramatic Publishing Co.,
Woodstock IL

PRODUCTION STAFF

Director	Thomas Woldt
Asst to the Director	Ann Niergarth
Scene Design	Andy J. Doebele
<i>Tour revisions by Sean P. McArdle</i>	
Costume/Lighting Designer	Eric Selk
Video Designer	Sean P. McArdle
Student Tech. Directors	James Hilmer, Ryan P. McArdle, Sean P. McArdle
Stage Manager	Jamie Ulmer
Assistant Stage Manager	Amy Beck
Costume Shop Supervisor	Eric J. Abbott
Space & Video Reference	Jim Falvo
Company Mgr.	Stephanie A. Quandt
Convention Coordinator	Ceri Daniels
Welding Supervisor	Shannon McCord

COSTUMES: Jared Price, Tyler D. Collins, Bethany Nelsen, Heather Richter, Melissa Bernadt, Jennifer Norquest, Sonja Hassler, Tanya Bunte, Peggy Sandall, Lori Vyhralek

SCENERY: Christine R. Bolles, Ken Schroeder, Heather Van Horn Looper, Monica Welch, Stephanie A. Quandt, Jason Weible, Nate Huber

LIGHTS: Scott Decker, Jason Schnell, James Khyn, Jennifer DeCamp, Carrie Zochol

PUBLICITY: Angie Pearson, Traci Hines, Rachelle Japp, Sarah Stape, Rochelle Smith, Tica Felise Perri

SOUND: Carrie Peek, Brett Sheridan, Libby Power, Dawna Gantvoort, Jason Thompson, Jenn Smith

PROPS: Amy Johnson, Patrick Stone, Miranda Benes, Laura Nickerson

MAKE-UP: Corey Horn, Angie Lewis, Heidi Haldeen

VIDEO: John Hladky, Robyn Phillips

RUNNING CREW: Jenn Smith, Amy Johnson, James Hilmer, Scott Decker, Amy Beck, Jason Schnell

Technical assistance by Theatre
workstudy, Stagecraft I and
Introduction to Theatre classes

SPECIAL THANKS TO

Tim and SueAnn Mouw, David Breckbill, Larry Monson, Jay Gilbert, Da Vincis, Omaha Community Playhouse, ALPO, LADD's Family Restaurant, Antique Shop, Doane Maintenance, Doane Faculty Secretaries, Doane Service Bureau, D.J. Welding and Manufacturing Inc., Horky's Shop, Doane Athletic Department, Kristin Roback, Sportsman Bar and Grill, Eric Anderson and TELEPRO, INC., Schaefer's TV, Dr. Kay Hegler, Dan Kunzman, Donna Jurena, Patrick Tuttle, George Clancy, Dr. Frederic Brown, Dr. Glen W. Davison, Pappy Khouri

FLOW MY TEARS

Flow my tears fall from your springs,
Exilde for ever, let me mourne
Where nights black bird hir sad infamy
sings,
There let mee live forlorne.

Downe vaine lights shine you no more,
No nights are dark enough for those
That in dispaire their lost fortunes
deplore,
Light doth but shame disclose.

Never may my woes be relieved,
Since pitie is fled,
And tears, and sighes, and grones my
wearie dayes
Of all joyes have deprived.

From the highest spire of contentment,
My fortune is throwne,
And feare, and grieffe, and paine for my
deserts,
Are my hopes since hope is gone.

Harke you shadowes that in darknesse
dwell,
Learne to contemne light,
Happie, happie they that in hell
Feele not the worlds despite.

--ANONYMOUS
Music by John Dowland, 1600

LISTEN TO THE SIRENS

"Flow My Tears"
The New Police Song
The Slogan Of Peace Is
"You Must Live"
They've Got Me
And I'm One Of Them
Cancel: "Silence"
They Screamed For Days
"We've Been Here Before
We Won't Stay"
They Can Die
They Can Just Turn Off
Some Vehicle Moves In Circles
Some People Need The Heroes
But I Don't Mind
I Don't Mind
Please Listen To The Sirens
We Don't Wish To Be Your Friends
Please Listen To The Sirens
We Won't Ever Call Again
Mister Webb
There Is Not Way Out
Love This Room
Please Don't Fight Your Walls
Can You See
I'm Wasting Your Time
A Streetcar's Rusting Unseen
Music Hall's Empty Like Me
But I Don't Care
I Don't Care
Please Listen To The Sirens
We Don't Wish To Be Your Friends
Please Listen To The Sirens
We Won't Ever Call Again
If I Could Stay Here For Now
With Someone Just A Bit Like You
"Oh No".
Maybe I Would Dream Again.
Of Someone Just A Bit Like You
"S'pose So".
Station Boys
Keep Their Hands On Steel
Tudeway Days
Now Seem Quite Unreal
It's Always So Close
But Never Quite Arrives.
My Vision's Like An Old Film. Shaky.
There's Nothing Through My Window.
OK.
No Photo By My Bedside. Black/White.
No Image In My Mirror. Bye Bye

Gary Numan and tubeway army, 1978

Southwest Missouri State University's
Dept. of Music and Dept. of Theatre &
Dance
present

THE RED HOUSE

Book, Music & Lyrics by Brett
Kristofferson

Additional Lyrics by Angela C. Schultz

Based on the 1945 novel by George
Chamberlain and the 1947 United
Artists Motion Picture

Director	Jack Parkhurst
Musical Director	Michael Casey
Scene Designer	Byrne Blackwood
Costume Designer	Cynthia Winstead
Lighting Designer	Angela Willis
Sound Designer	Mark Coble
Orchestrations	Brian Perkins
Technical Director	Steven George
Scene Shop Manager	Jeff Cole

THE ENSEMBLE

Pete Morgan	Barry Curtis
Ellen Morgan	Kendra Kassebaum
Meg Morgan	Sarah Tannehil
Rebecca Storm, Voice of Genie	Karen Kanakis
Nath Storm	Greg Robinson
Tibby Rinton	Gina Stockton
Teller Truman	Matt Williamson

Time, 1947, Somewhere in the Midwest

*Additional lyrics for THE RED HOUSE
were contributed by Angela C. Schultz,
who played a major part in the original
concept and design of the show. Further
lyrics have been contributed for this
production by the cast.*

ACT I

Opening	Orchestra, Company
If I Brought You Roses	Nath
Screaming in the Night	Pete, Ellen, Nath
Silently	Meg
General Store	Rebecca
I Remember	Ellen
Mothers and Sons	Rebecca, Pete
Something in the Way	Meg, Tibby, Nath
Faint, Familiar Song	Nath
Spinning	Tibby
Meg's Soliloquy	Meg, Company

10 minute intermission

ACT II

Entr'acte	Orchestra
Lullaby	Ellen, Company
Done with Playing the Fool	Nath, Tibby
Reprise, Screaming in the Night	Pete, Ellen
Montage: Time Goes By	Company
Nothing More to Say	Meg, Nath
Finale	Pete, Company

PRODUCTION STAFF

Assistant Director	Amy Miller
Stage Manager	Eric Little
Vocal Coach	Pearl Yeadon
Musical Coordinator	Brian Perkins
Manager	Byrne Blackwood
Business Manager	Lynn Danforth
House Manager	Jeff Allen
Publicity/Program	Deborah DeWitt Jeff Allen

RUNNING CREW

Properties Master	Nathan Michael
Deck/Props Crew	Justin Hudson, Rick Piles, Amy Williams
Lights	Katherine Novak
Sound	Tom Oster
Flies	Brad Price, Cindy Svezia
Wardrobe	Brian Fowler, Hollie Howard

ORCHESTRA

Conductor Michael Casey
Piano Heather Chittenden-Luellen
Percussion Lisa Dahlstein
Synthesizer Brian Perkins
Jason Slifford

PRODUCTION CREW

LIGHTING Assistant: Angela Willis
Crew: Molly Barrere, Carla Bradley, Sage Chittock, Shelley Corcoran, Andrea Dial, Ellie Edwards, Amy Henne, Shanon Horn, Jennifer Logan, Megan Palensky, Cindy Svezia, Dara Yeksavich

SCENERY & PROPERTIES Assistants: Sage Chittock, Steve Eisenhart, Justin Hudson, Bracy Martin, Shawn Martin, Nathan Michael, Tom Oster, Rick Piles, Aaron Spivey, Andrea Toombs
Crew: Manuel Arango, Heather Bair, Tiffany Barney, Carla Bradley, Toyna Bull, Kate Howard, Kevin Jones, Robert Keller, Rachael Kilgore, Chrissy Martens, Troy Metcalf, Joe Parisi, Laura Price, Courtney Roberts, Carrie Rosales, Andrea Toombs, Michael Wilks, Angie Wingo

COSTUMES Assistants: Manuel F. Arango Diez, Heather Bair, Melanie Coffey, Jennifer L. Hoefakker, Robin Martin, Nalika Roper
Crew: Molly Barrere, Tonya Bull, Nick Cusumano, Traci Dunn, Ellie Edwards, Justin Hudson, Glenn Kornblum, Julie Jordan, Eric Little, Kelly Martorelli, Dawn McClain, Misty Radzinski, Derek Russell, Tina Sandstorm, Cindy Svezia

MUSIC PREPARATION: Bjorn Mercer, Luke Kratz

SPECIAL THANKS

Angela C. Schultz, Dr. David Belcher, Dale Everett, Eric Griffin, & Mark Coble

DIRECTOR'S NOTE

A vision in the mind of an author takes a collaborative effort to come to life on stage. *The Red House* is no exception. It has been an ongoing project for the last two years. In that time I have had the pleasure of working with many talented and dedicated individuals, particularly this cast. They have been patient, creative and very helpful as this "version" of the play surfaced. They provided lines, thoughts and most of all the willingness to work through many changes without a sign of negativity. I owe them many thanks and a great deal of appreciation.

I would be remiss if I did not mention those faculty and students who have supported this project along with those who gave this production the visual elements that help create the world of the play. The designs and execution of those designs do not come about by accident. I would specifically like to thank John Prescott who was the driving force behind the development of the project. Martin Jones, Robert Bradley and Becky Parkhurst provided important observations in the development of the text. Also, special thanks to Pearl Yeadon, Heather Chittenden-Luellen and especially Michael Casey. The contribution these people made to the development of *The Red House* is immeasurable.

Finally, we would all like to thank playwright Brett Kristofferson for his music and book. Thanks, Brett!

--Jack Parkhurst

The University of Kansas
The University Theatre Presents

Moliere's
TARTUFFE
comedy in 5 acts, 1669
translated into English verse by
Richard Wilbur

Director Ron Popenhagen
Scenic Designer Vaughn Schultz
Lighting Designer Delbert Unruh
Costume Designer Delores Ringer
Dramaturg/Movement
Consultant Ludvika Popenhagen

CAST OF CHARACTERS

Mme Pernelle, Orgon's
Mother Lee Wolfe
Orgon, Elmire's
Husband David L. Prentiss
Elmire, Orgon's Wife Louise M. Flory
Damis, Orgon's Son,
Elmire's Stepson James Wallert
Mariane, Orgon's
Daughter, Elmire's
stepdaughter, in love
with Valère Amy R. Steinhaus
Valère, in love
with Mariane Trevin Gay
Cléante, Orgon's brother-
in-law, Elmire's
brother Nicholas A. Miller-Schlyer
Tartuffe, a hypocrite
(the Imposter) Sean C. Holland
Dorine, Mariane's
lady's-maid Julia Kessler
M. Loyal, a bailiff Brenda Leff
A Police Officer (Louis
XIV's envoy) Jerry John Buszek
Flipote, Mme. Pernelle's
maid Lawrence Eric Davis
Maitresse de
Maison Jennifer L. Attocknie
Butler Brian Wicks
Porter Trevin Gay
Valet Lee Wolfe
Courier Lawrence Eric Davis
Lackey Brenda Leff
Flunky Jerry John Buszek

SETTING

The scene throughout: Orgon's house in Paris (The Marais in October). There will be a 15-minute intermission between Acts III and IV. Produced by special arrangement with Dramatists Play Service, Inc.

PRODUCTION STAFF AND CREWS

Asst Director Jeremy W. Auman
Asst Costume Designer Galina Urman
Stage Manager Kristen Gillaspie
Graphic Designer Katherine Oliver
Scenery & Properties Lark Oxler,
Robert Bailey, Mat Hostetler,
Jamie Najim, Teague Hayes
Lighting Branka Grubor
Costumes Erin Kessler, Leigh
Bowersock, Martha Romano
Make-Up Lee Wolfe, Blair Bitters

ACKNOWLEDGEMENTS

This production features recordings by James Higdon, Professor of Organ at KU, performed on the Cavallé-Coll Organ (1879) in Saint-François-de-Sales, Lyon, France. Compositions by Camille Saint-Saëns (1835-1921) and Marcel Dupre (1886-1971) frame the action of *Tartuffe*. Professor Higdon's recordings are available at Kief's Discount Records in Lawrence.

DRAMATURG'S NOTE

Moliere's work as professional playwright, actor, and manager of his own theatre company extended over a period of 30 years. *Tartuffe* appeared late in his writing career, by which time his comedies had matured from farce into a carefully constructed and profound dialogue spiced with witty repartees and absurdities. Moliere complied with the rules of French Neoclassicism, which meant that he had to write his comedy in the Alexandrine meter (12 spoken syllables to the line). Richard Wilbur has succeeded in translating Moliere's comic *esprit* by using a meter which is preferred by English speakers: the iambic pentameter (10 syllables to the line).

This play addresses several social issues, the most prominent being feigned religious ardor. The character Tartuffe, pretending to be pure in heart and reverential, dupes and almost ruins his pious host, Orgon, and his family. Only his wife, Elmire, and his daughter's *suivante*, Dorine, are able to outwit Tartuffe.

At its first representation in 1664, this play was banned on the grounds that it mocked religion and its devout practitioners. When the revised and expanded *Tartuffe* opened at the Palais Royal in 1669, it was the greatest box office success to date in French theatre.

--Ludvika Popenhagen

DIRECTOR'S NOTES

Tartuffe begs to be put into motion--to be seen as well as heard. As with all of Moliere's comedies and farces, gestural virtuosity is dormant in the text. The *mise en scene* animates *Tartuffe*'s words and layers them with the resuscitated body of Moliere's world.

The role of Orgon, written for Moliere himself, embodies completely the rhythm and playfulness of the actor-playwright. The other roles, written for Moliere's devoted company of actors, embody each of their individual rhythms and characteristics. Likewise, beyond the surface texture of the play's words reside the fixed roles and half-masks of the *Commedia dell'Arte*. Moliere has absorbed the mask form of the Italian comedians into the mobile faces of his comic characters. *Tartuffe*, then, is an actor's dream. It offers each actor the opportunity to personalize a fixed role and to discover, within this limitation, the joy of "playing at being."

--Ron Popenhagen

STAFF

UT Secretary	Michael Boring
Costume Technician	Renita Davenport
TH & F Secretary	Eula Fuller
TH & F Office Manager	Marilyn Heath
Manager, Development & Ticketing	Linda Hope
Photographer	Earl Iversen
Dir. Public Relations	Charles Jenkins
Scene Shop Coord.	Thomas J. Mansfield
Technical Director	Jim Peterson
Asst. Dir. of Theatre	Katherine L. Pryor
Bookkeeper	Rosie Rankin
Stage Manager	Alexander Weston

KC/ACTF XXVII

Kennedy Center American College
Theater Festival XXVII

Presented and produced by
The John F. Kennedy Center
for the Performing Arts

Supported in Part by
The Kennedy Center Corporate Fund
The U.S. Department of Education
Ryder System

The productions presented at this Festival are entered in the Kennedy Center American College Theater Festival (KC/ACTF). The aims of this national theater education program are to identify and promote quality in college-level theater production. To this end, each production entered is eligible for adjudication by a regional KC/ACTF representative, and certain students are selected to participate in KC/ACTF programs involving awards, scholarships, and special grants for actors, playwrights, designers, and critics at both the regional and national levels.

Productions entered on the Participating level are eligible for inclusion at the KC/ACTF regional festival and can also be considered for invitation to the non-competitive KC/ACTF national festival at the John F. Kennedy Center for the Performing Arts in Washington, DC, in the spring of 1995.

The KC/ACTF is a program of the Kennedy Center Education Department, which also includes youth and family programs, professional development opportunities for teachers, and performances for school groups, the Kennedy Center Alliance for Arts Education, the Performing Arts Centers and Schools Program, performance enhancement events, national and community outreach initiatives, the Kennedy Center Internship Program, and the National Symphony Orchestra education program. The Kennedy Center also works closely with Very Special Arts, an educational affiliate of the Kennedy Center.

Last year more than 800 productions and 17,000 students participated in the American College Theater Festival nationwide. By entering this production, these departments are sharing in the KC/ACTF goals to help college theater grow and to focus attention on the exemplary work produced in college and university theaters across the nation.

RESPONDENTS AND ADJUDICATORS

ROBERT R. BUSEICK, Ryan
Semi-Finals Adjudicator, holds an MFA from the University of Portland, spent a year of study at the Central School of Speech and Drama in London, England, and is in his twenty-sixth year at Centenary College. There, he has made major contributions to the Shreveport theatre scene with over 150 production. His favorite playwright is Tennessee Williams and his dream is to eventually direct all of Williams' plays. To date he has directed *Battle of Angels*, *Camino Real*, *The Glass Menagerie*, *Night of the Iguana*, *A Streetcar Named Desire*, *Suddenly Last Summer*, *Summer and Smoke*, *Sweet Bird of Youth*, *Talk to Me Like the Rain and Let Me Listen*, *This Property is Condemned*, and *Vieux Carre*.

Buseick has been involved with KC/ACTF since 1971 and has presented productions at the Region VI festival including *The Adding Machine*, *Peg O' My Heart*, and *So Long on Lonely Street*. *My Sister In This House* was selected to play at the Kennedy Center National Festival. He has been honored with two Kennedy Center bronze medallions. He has served KC/ACTF as Louisiana Vice-Chair, Chair, and Region VI as Vice-Chair. He is in his second year as Chair of Region VI.

ALEX CHRESTOPOULOS,
Festival Respondent, professor of acting and voice, teaches Shakespeare as a member of the graduate faculty at Southern Illinois University at Carbondale. He has been involved in KC/ACTF since 1970 as a student, director, and National Committee Member. He has directed, acted, or sung with such companies as the Old Globe Theatre in San Diego; the Arizona Theatre Company; San Diego Opera Company; The Invisible Theatre; Starlite Summer Musicals; Hilton Head Playhouse; and the Savannah Theater Company. His academic guest artist credits include the Universities of

Arizona, Nevada-Las Vegas, South Carolina, and Tennessee. He has held offices in the Georgia Theater Conference, Southeastern Theatre Conference, and the Illinois Theatre Conference. He served as a consultant to the Georgia Department of Education for their theatre curriculum study. He recently completed a term on the Illinois Arts Council Opera and Choral Panel. Chrestopoulos holds a BFA from U.S. International University's School of Performing Arts and an MFA from the University of Arizona.

LAUREN FRIESEN, Irene Ryan Semi-Finals Adjudicator, is the KC/ACTF Region III Chair and Professor of Drama at Goshen College. Prior to serving as Chair he was Region III's Playwriting Chair. In 1993-94, while assistant dramaturg at the American Conservatory Theatre in San Francisco, he also held the position of Visiting Scholar at Stanford University's Drama Department. Dr. Friesen has been a frequent judge for playwriting competitions including the Morton Sarratt Award at the University of Nevada-Las Vegas and the Waldo Bonderman Award at Indiana.

Friesen's own plays have won national distinction. *The Urban Puma* received first place in the San Jacinto One-Act Competition. *King David*, a 3-act play, was published by Samuel French, Inc., in 1991. *Hawk Feather*, a two-act play rooted in Native American traditions, received favorable reviews in its 1994 premier. Bruce Hostetler from Indiana Repertory Theatre will direct the premier of *The Platte River Trilogy* in the summer of 1995. One of the three one-acts from this trilogy is a featured reading at the Region V Festival; you may attend on Saturday at 10:15 a.m., in Lancaster 5,6.

At Goshen College Dr. Friesen directs the New Plays Program. In ten years this project has produced 4 full-length and 31 one-act original plays. Dr. Friesen frequently lectures nationally and internationally.

DAVID MARK COHEN, New Play Development Respondent is former National Playwriting Awards Chair for KC/ACTF. An active playwright, dramaturg, director, critic, and educator, Cohen received his MFA in Playwriting from Brandeis University, where he studied with noted playwright Israel Horovitz. He made his Broadway writing debut at age 24 with *Piaf--A Remembrance* for which Juliette Koka won a Theatre World Award. His other writings include *Tanglewood* and *Friends Indeed!* (Off-Off Broadway); *Where Credit Is Due* (Regional); *The Incredible Dream* (PBS-TV with Ed Asner); and the feature film, *Friday the 13th: Part V*.

His professional associations range coast-to-coast from LA's Mark Taper Forum to Cape Cod's Provincetown Playhouse. Currently he heads the MFA Playwriting Program at the University of Texas at Austin, where he holds the Fellowship of the Bennett Cerf Professorship in Creative Writing at the Texas Center for Writers. He is also Graduate Studies Chair for the new multi-disciplinary MFA in Writing through this James A. Michener-supported Center. Additionally, he is Resident Playwright and Director of New Play Development at Austin's Capitol City Playhouse, and is Theatre Critic for the award-winning *Texas Triangle*. He is a member of the Writers Guild and Dramatists Guild of America.

PAUL J. HUSTOLES, KC/ACTF Region V Chair, is currently Professor and Chair of the Department of Theatre Arts at Mankato State University, Minnesota, where he has also been Artistic Director of Highland Summer Theatre since 1985. Dr. Hustoles received his BFA from Wayne State University, his MA from the University of Michigan, and his PhD from Texas Tech University. A college instructor for over twenty years, he has taught in Missouri, Texas, Mississippi, and Michigan. His specialities include acting, directing, musical theatre, theatre management, and theatre history.

Hustoles practices what he preaches, having directed over 115 shows and having produced over 300. He was Artistic Director of the Mule Barn Theatre, Tarkio, Missouri, for six years, and will

celebrate his 24th year of summer stock in 1995. At Mankato State he has represented the College of Arts and Humanities to the Executive Committee of the Faculty Association, has been Secretary pro tem for that organization, and was Speaker of the Faculty Senate when he became Acting Vice President for University Advancement and Secretary of the MSU Foundation Board, serving in those positions for 15 months. He is listed in *Who's Who In America*, *Who's Who In Entertainment*, and *Who's Who in Education*. Paul is a past Vice Chair of Region V North of the KC/ACTF.

LARRY L. KUBERT, National Critics Institute Critic, has been reviewing national, regional, and local theatre for 21 years, the last 15 as theatre critic for the *Lincoln Journal* newspaper. He also writes a weekly theatre and dance column for *Focus* magazine, an entertainment supplement for the *Sunday Journal-Star* newspaper.

In addition to theatre, Kubert has reviewed dance, film, restaurants and books. He has also written for *Billboard* magazine. Besides his affiliation with the *Lincoln Journal*, he is a publicist with Nebraska Educational Telecommunications, which houses the Nebraska ETV Network and the Nebraska Public Radio Network. He is assistant editor of Nebraska ETV's monthly viewer's guide, *CHOICE* magazine. Kubert is a jazz, blues and Cajun/zydeco programmer on KZUM-FM, a community radio station in Lincoln, and is a member of King & Kubert, a performance duo offering songs and stories for youth.

Kubert holds a Bachelor of Arts degree from the University of Nebraska-Lincoln's College of Journalism and Mass Communication. He has taken graduate hours in theatre arts at UNL.

HARLENE MARLEY, Festival Respondent, is Chair of the Department of Dance and Drama at Kenyon College in Gambier, Ohio, where she teaches directing, acting, and playwriting. She was the first woman faculty member at Kenyon and its first woman department chair. She received her BA in Theatre from Oklahoma City University and her

MFA from Carnegie Mellon University in Pittsburgh. She has also studied at Arizona State, Indiana University, and Tulane University, and received certificates from the Università per Stranieri in Perugia, Italy, and from the Harvard Business School in arts administration.

An active participant in KC/ACTF for more than a decade, she currently serves as chair for the National Playwriting Awards Committee. In 1989 she received the KC/ACTF Gold Medallion for Excellence. In 1990 she was awarded a research fellowship by the American Association of University Women.

JUDITH ROYER, Ryan Finals Adjudicator, teaches acting, directing, and playwriting at Loyola Marymount University in Los Angeles. She has directed over 30 revivals and 25 original scripts. She has worked as producer, director and dramaturg with new play development programs sponsored by the National Endowment for the Arts, Playwrights Theatre, The Mark Taper Forum, and Theatre Gallery in Los Angeles, of which she is founder and former artistic director. Most recently she has been producing director for the Southern New Plays Festival, sponsored by Southern Repertory Theatre in New Orleans, and is currently a Participating Artist with Alice's Fourth Floor, New York City.

Royer is a founding member of the Association for Theatre in Higher Education; has recently served as Chair and is current Conference Planner for the Association's Acting Forum; and is co-director of ATHE's annual New Play Development Workshop. She is a member of the KC/ACTF Region VIII Board of Governors and is that region's current Playwriting Awards Committee Chair.

CLYDE RUFFIN, New Play Development Respondent, is Professor and Chair of the Department of Theatre at the University of Missouri-Columbia, where he has been on the faculty since 1983. He holds a BA degree in Speech and Dramatic Art and an MFA in Performance from the University of Iowa. He is a member of the African-American Arts Task Force for the Missouri Arts Council and the Art for Life Advisory

Board for University Hospitals and Clinics. Professor Ruffin has worked extensively to promote excellence in the arts as a site reporter for The National Endowment for the Arts and regional judge for the American College Theater Festival.

Founding director of the University of Missouri's award-winning Black Theatre Workshop, for the past 14 years Ruffin has designed costumes for the Metro Theatre Company, most recently for the St. Louis Repertory Theatre production of *Once On This Island*. Professor Ruffin is a Kellogg National Fellow and recipient of the National Leadership Conference Service Award, the Purple Chalk Award for Outstanding Undergraduate Teaching, and the William T. Kemper Fellowship for Excellence in Training.

JO ANN SCHMIDMAN, Ryan Semi-Finals Adjudicator, founded the Omaha Magic Theatre, a non-profit foundation for the performing arts, in 1968. Since that time, Omaha Magic has thrived under her continuous artistic direction. Her long collaborations with Megan Terry (1970-present) and Sora Kimberlain (1980-present) have resulted in many acclaimed innovative works for the theatre, changing the face of the contemporary American theatre.

Upon completion of her BFA from Boston University School of Fine Arts in 1970, she was invited to join Joseph Chaikin's experimental Open Theatre, NYC, as a performing member. She toured with the Open throughout the US, Canada, Europe, and the Middle East. She has lectured with internationally renowned playwright Megan Terry, has conducted extensive workshops in performance techniques, and has taught playwriting and poetry at universities, juvenile/adult penal facilities, junior and senior high schools, Indian reservations, to senior citizens and for young people. With the Omaha Magic Theatre Company she has toured extensively throughout the midwest and both coasts with many of the OMT repertoire of new works.

The OMT is currently touring with *Belches On Couches*, *Sound Fields*, and *Body Leaks*.

R. CRAIG WOLF, Festival and Design Competition Respondent, has taught at the Universities of Michigan and Virginia and is currently Professor of Design and head of the Design Program at San Diego State University. His designs have been seen nationwide, including productions for San Diego's Old Globe Theatre, Dance Theatre Workshop in New York, the Richmond Ballet Company in Virginia, Theatre Artaud in San Francisco, and the Japan America Center and Odyssey Theatre Ensemble of Los Angeles.

Mr. Wolf is the author of the lighting section of *Scene Design and Stage Lighting*. This influential college text is now in preparation for its seventh edition. He is the Lighting Commissioner of USITT, the American Association of Design and Production Professionals in the Performing Arts. He is a member of the United Scenic Artists Design Union.

DAN PLATO, Chair of Playwriting for Region V of the KC/ACTF, has, over the past ten years with ACTF, served as Louisiana Vice-Chair, a member of the selection team and design coordinator for the Southern Region, an Irene Ryan judge for 9 of 10 years (last year's weather finally got him...), and as Vice Chair of Playwriting for Region V. His play, *The Medea Myth*, has been performed nationwide and in Canada, and received a KC/ACTF award for playwriting when it was performed in Region V by the University of Kansas. Plato currently serves as chair for the Department of Theatre Arts at the University of North Dakota.

WORKSHOP LEADERS

JAY SCOTT CHIPMAN is spending this year as a Visiting Instructor of Communication and Theatre Arts at Nebraska Wesleyan University. He is in the process of completing a Ph.D. in Theatre History and Performance Studies at the University of Pittsburgh, where he directed for the Three Rivers Shakespeare Festival and wrote and directed five one-person performances.

ROBERT CHRISTOFFERSEN has worked in video, film, theatre, music, and the recording industry for over 20 years. He has worked with a wide range of talent, troupes, and productions over the years, from Henry Fonda and Vincent Price to Jason Robards and Eva-Marie Saint this past summer during the filming of *My Antonia*. Some of his past commercial clients for whom he has written, shot, produced, or directed include ITT/Hartford, FFE Express, Catholic Mutual Inc., Senior Technologies Inc., and Warner Home Video. He received a 1993 Silver ADDY Award from the Advertising Federation of Lincoln [Nebraska] as producer/director for a trailer for Earth Island Institute which was placed in the video home release of the Warner Brothers movie, *Free Willy*. He currently works as a free-lancer and has just received a grant from the Southwest Area Media Project to continue preproduction research on a documentary on the Opera House Era in American Theatre history.

WILLIAM C. FOX, a graduate of the Goodman School of Drama of the Art Institute of Chicago, has been Technical Director for the Century II Arts and Convention Center for the past twelve years. He has worked in all aspects of theatrical production from drafting curtain and rigging layouts for Art Drapery Studios in Chicago, to selling scene paint and stage hardware for Associated Theatrical Contractors in Kansas City, to Technical Director for 40 Music Theatre of Wichita productions. His scenic/display company, Technical Directions, is contractor to some of America's most familiar industrial names.

MARK A. KLEMETRUD, currently teaching Intermediate Acting and Diction and Dialects at the University of Nebraska-Lincoln, has extensive experience writing, producing, and performing one-person shows. He began in 1976 by writing and directing *Rebels and Redcoats* for the Northern States Bi-Centennial Lyceum Tour. He received critical acclaim for his performance in *Clarence Darrow: Attorney for the Defense*, which toured the Midwest in 1982-3. Klemetsrud now spends his summers performing several one-person shows based on Theodore Roosevelt for the North Dakota State Historical Society and the Theodore Roosevelt National Park. He received his MFA in Acting from the University of Nebraska-Lincoln.

VICTORIA MARSHALL, assistant Professor at the University of Missouri-Kansas City Theatre Department in Design/Tech, is also Associate Resident Costume Designer for the Missouri Repertory Theatre. A former Hallmark artist and free-lance illustrator, she designed and illustrated a series of internationally published children's Bible stories. She is part owner of the Artists' Co-Op Gallery in Kansas City, Missouri.

SHIRLEY CARR MASON,

Assistant Professor of Theatre at the University of Nebraska-Lincoln, teaches voice, undergraduate and graduate Acting and Shakespeare/English Renaissance studies. Her academic Shakespeare background includes the prize in Shakespeare Studies from Bedford College, University of London; doctoral studies in *Richard III* with the help of the George F. Reynolds Fellowship at the University of Colorado; and the Schallek Memorial Fellowship from the Richard III Society. Dr. Mason (as Shirley Carr Grubb) has published in *The Shakespeare Quarterly* and *On Stage Studies*. Additionally, Mason has worked with the Berkshire Shakespeare Players at the Watermill Theatre, Bagnor; with the Colorado Shakespeare Festival as actor, sound designer, and dramaturg; with Shakespeare and Company in Massachusetts as an actor, where she trained in voice and text with Tina Packer and Kristin Linklater; and as an actress with the Nebraska Repertory Theatre. While at UNL, she has directed *Measure for Measure* and *Twelfth Night*.

ROBIN McKERCHER, MFA

Directing Candidate at the University of Nebraska-Lincoln, is a member of United Scenic Artists #829. His Broadway credits include the responsibility of Charge Scenic Artist for *Aspects of Love*, *Nick and Nora*, *The Red Shoes*, and *The Secret Garden*. In the spring, McKercher will teach scene painting and direct *Our Country's Good*, his thesis production.

ANN NIERGARTH received her

MFA in Acting from the University of Nebraska-Lincoln, where she performed such diverse roles as Isabella in *Measure for Measure*, Agave in *The Bacchae*, Betty/Edward in *Cloud 9*, and Blanche in *A Streetcar Named Desire*, which toured to Japan. Her professional work includes three seasons of major and supporting roles with the Nebraska Repertory Theatre; training at the National Shakespeare Conservatory in New York, and numerous touring and regional companies in the Detroit, Michigan area. Niergarth's teaching experience includes Beginning and Intermediate Acting, Voice and Movement at UNL, residencies ranging from a touring children's production to college Guest Artist appointments, and ongoing workshops in creative movement, voice, and acting.

CHARLES O'CONNOR, Assistant

Professor at the University of Nebraska-Lincoln, is a member of United Scenic Artists #829 and the Society of Motion Picture and Television Art Directors IATSE #876. He won the CableAce Award for Outstanding Art Direction on cable television. He holds an MFA from the University of Southern California.

DOUG PATERSON, Professor of

Theatre and a designer at the University of Nebraska-Omaha, has studied with Augusto Boal for a number of years in both the United States and Brazil. He brought Mr. Boal to the United States in the summer of 1992 as keynote speaker and for a series of workshops at the national meeting of ATHE, the Association for Theatre in Higher Education. Through Paterson's efforts, Boal will present a series of workshops in Omaha in February, 1995. Paterson is the newly-elected ATHE Vice President for Planning and Projects.

DANA PINKSTON is currently a

faculty costumer at Kansas State University.

PAUL STEGER, Assistant Professor in the Department of Theatre Arts and Dance, spent last summer at the Wisconsin Shakespeare Festival, where he choreographed 46 fights for productions of *The Three Musketeers* and *Henry V*, while performing the roles of Aramis in *Musketeers* and Pistol in *Henry V*. He has choreographed fights for numerous productions and regularly directs on the UNL mainstage.

Steger's movement skills come primarily from private training with Wayne Loui, Richmond Shepard, and Marcel Marceau. His stage combat skills have been acquired with many Fight Masters certified by the Society of American Fight Directors (SAFD), and he has also studied with Masters Henry Marshall and Jonathan Howell of the Society of British Fight Directors and Patrick Crean and John Brogan of Fight Directors Canada. He currently serves as regional representative for the SAFD in Nebraska, Kansas, and Oklahoma. He is also a founding member and regional representative for the Association of Theatre Movement Educators (ATME).

MEGAN TERRY, author of such distinguished plays as *Viet Rock*, *Approaching Simone*, *Hothouse*, and *Comings & Goings*, currently tours as a performer with the Omaha Magic Theatre's productions of *Belches on Couches*, *Body Leaks*, and *Sound Fields*, which she co-authored. Named 1992 Nebraska Artist of the Year by Governor Ben Nelson, Terry writes interactively for actors and audiences. Her newest works for the theatre are spectacular new art performances, multi-media productions in which she has collaborated with other strong artists from many disciplines. Her most recent plays are examples of her unique contributions to the American theatre--the making of musical theatre with serious themes, a further evolution of her innovative 60s work, *Viet Rock* and *Approaching Simone*, which won the Obie Award.

Since 1966, Terry has been changing the face of the American theatre with such innovations as transformation plays, the formalization of theatre games into play structures, docudrama, *theatre verite*, and

performance art pieces. Helene Keyssar, in her book *Feminist Theatre*, calls Terry "the mother of feminist theatre." She is a founding member of the famed Open Theatre where, in 1966, she developed this country's first rock musical, *Viet Rock*.

An incisive writer and charismatic teacher, Terry is highly sought-after as lecturer and seminar leader. She has most recently conducted seminars and workshops at the 1993 Playwright's Center/McKnight National Residency Artist; University of Iowa Writers Playwright's Workshop; the Summer Arts Collaborative Theatre Project; the Dramatists Guild Outreach Conference; Swarthmore College; the University of Minnesota; the ASSITEJ World Theatre Symposium; and the Contemporary Arts Center in New Orleans. Her works are featured in a number of important books on American theatre, including *American Playwrights Since 1945* and *Gender In Performance*. She holds numerous awards, most recently being elected to the College of Fellows of the American Theater, where she was installed during the 1994 KC/ACTF festivities, in recognition of her "Distinguished service to the profession by an individual of acknowledged national stature."

KATE UFEMA, Voice and Speech Specialist in the Professional Actor Training Program of the Department of Theatre at the University of Minnesota, Duluth, is also an Equity actress and singer, a professional director, musical director, vocal/dialect coach, and a professional voice consultant, voice trainer, coach and therapist. She trains and coaches voices in all the performance media, including major contracts with CNN, CBS, NBC, ABC, National Public Radio and American Public Radio. She has acted and directed across the country, and has presented workshops and adjudicated theatre competitions and festivals from Colorado to the East Coast. Kate is a charter member of VASTA, the Voice and Speech Trainers Association, and is currently its treasurer. She holds BA, MA, and MFA degrees from Penn State University.

SANDY VENEZIANO, Artistic Director for the Nebraska Repertory Theatre and instructor at the University of Nebraska-Lincoln, is a member of the Society of Motion Picture and Television Art Directors IATSE #876. After earning her Bachelor of Arts degree in 1974 and two masters degrees in 1975 and 1978, Veneziano traveled to Hollywood, where within one month she landed her first job as a set designer for the hit television show, *Dallas*. Among her credits are *Stripes* and *Terms of Endearment* and she boasts Art Direction credits for the popular television series *Star Trek: The Next Generation* and the movies *Dead Poets Society* and *Home Alone 2*.

LEWIS E. WHITLOCK III, a Minnesota native, has danced in venues worldwide, including on Broadway in *The Wiz*, *Zoot Suit*, and *Reggae*. He has acted, choreographed, and directed many productions at the Chanhassen Dinner Theatre, the Guthrie Theatre, Arizona Theatre Company, the Minnesota Opera, Galveston Outdoor Musicals, Plymouth Playhouse, Highland Summer Theatre, Theatre L'Homme Dieu, and Des Moines Community Playhouse.

Whitlock has choreographed works for the Alvin Ailey Workshop, the Okra Dance Company, Zenon Dance Company, the Duluth Ballet, and the Dance Company of the National Center of African American Artists. At present, he is an Assistant Professor in Theatre Arts at Mankato State University.

THE IRENE RYAN ACTING SCHOLARSHIP REGION V NOMINEES

(as of January 13, 1995)

COLORADO

Colorado State University Kelly Rae McKibben
Colleen Ann McLuckie
Tom Slovick
Tresa Waggoner

Fort Lewis College Danue Gordon

Mesa State College Darren Anderson
Susan Haldeman

Western State College Keni Tullio

IOWA

Briar Cliff College Laura Fernandez
Aaron T. Moore

Coe College Wendy Nolte
Jason Wichman

Cornell College Jennifer Carmichael

Dordt College Mark Du Mez
Colleen Kuiper
Sara Modderman
Chris Ornee

Drake University Kevin McKillip
Laureen Vignovich

Grinnell College Rachel Farris
Sara Gavitt
Louise Schoggen

Iowa State University Scott Nath
Cara Peterson
Chris Price

Simpson College Pamela Banning
Charles Pehrson

St. Ambrose University Wade Fields
Kimberly Kurtenbach-Speak
Tim Olson

University of Iowa Eric C. Johnson
Donald P. McClure

University of Northern Iowa
Joye Cook
Brett S. Thatcher

KANSAS

Butler County Community
College
Steve Carron
Ann Patton

Emporia State University
Jennifer Carra
Brian Davidson
Megan Evans
Katie Johnson
Kerensa Peterson

Fort Hays State University
Suzzette Grimsley
Eric Luetters

Garden City Community
College
Kory Oplinger
Mindy Woodard

Independence Community
College
Holly Ann Hammer
Cordelle Jordan

Johnson County Community
College
Vince DeLaughder
Matthew W. Fowler

Kansas Newman College
Shelly Coleman
Sarah Compton

Kansas State University
Tim Aumiller
Travis Malone
Amanda K. Sneed
Caisha Williams

Ottawa University
Blakeley L. Good
Daniel M. Grummon
Mary L. Hepner
Christopher M. Massey
Mary Lynn McMichael
Michael E. Robinette

Southwestern College
Shawn Franklin
Heather Jacobs
Angela Mayorga
Sean Quinlan
J.D. Smith
J.D. Tucker

University of Kansas
Kevin Comer
Douglas Dezzanni
Linda Graziano
Sean Holland
Brian Paulette
W. Scott Pinkston
David L. Prentiss
Caran Snitz

Washburn University
Jeff Boye
Tom Harmon
Judd Mason

Wichita State University
Jason Bailey
Damian L. Brown
Dennis Cleary
Haidee Goehring
Earnest Roberson
Monte Wheeler

MINNESOTA

Bemidji State University
M. Curtis Grittner
Marcy Miller

Macalester College
Jeffrey Nelson
Danielle O'Hare

Mankato State University
Eric J. Bakker
Anthony Crep
Steve Deutsch
Paul Kramer
Emily Walter
Mark Withers

Moorhead State University
Michael Klug
Thomas Schwans

Saint Mary's College of
Minnesota
Vicki Kleist
Peter Sellers

St. Cloud State University
Erin Johnson
Jon T. Olson

St. Olaf's College
Sarah Brandenburg
Dan Nyckelmoe

University of Minnesota,
Duluth
Gina DeBenedet
Julie MacIver
Carrie Rossow
Andy Wilkowske

Winona State University
Kevin Moore

MISSOURI

Avila College
Sean Galvan
April Dawn Gladu
Meghan Harris
Jason Jefferies

College of the Ozarks
Mike Bliss
Jeff Michael

Fontbonne College
John Fischer

Longview Community College
Christopher Holler

Northeast Missouri State University
Kenner L. Estes
Brian P. Healy
Kate McDoiel
Tim Naegelin

Northwest Missouri State University
Brandon Bernard

Southeast Missouri State University
Bob Clubbs
Amy Jo Diebold
Patrick Rebmann
Subrina Robinson

Southwest Missouri State University
Brian Bethel
Helena K. Cosentino
Sean McEwen
Danyel Read
Greg Robinson
Sarah Tannehil

St. Louis Community College at Meramec
Krissie Luke
Brad Tonkel
Matthew Walkenbach

Washington University
Katharine Powell
Caren Schmulen
Pamela Sloane

Webster University
Steve Broadnax
Robert D'Haene
Holly Kinnaird
Doan Myles MacKenzie
Andrea Osborn

NEBRASKA

Chadron State College
Wayne Asbury
Anne Buckingham

Concordia College
Brenda Glenn
Paul Roggow

Doane College
Scott Deker
Amy Jean Johnson
Ryan McArdle
Libby Power
Brett Sheridan
Jamie Ulmer

Nebraska Wesleyan University
Anthony Clark-Kaczamerak
Matthew Geiler
Angela Jenson
William R. Whitney

Peru State College
Brian Steele

University of Nebraska-Kearney
Todd Lisenfeld
Carol Money
Ryan Walters

University of Nebraska-Lincoln
Sharon Bigelow
Jonas Cohen
Julie Fitzgerald
Dean Houser
Mark Klemetsrud
Joan Korte
Alice Perry
Charles Russell
Michael Solomonson
Patrick Tuttle

University of Nebraska-Omaha
Lissa Hall
Christi Johnston
Jenni O'Rourke
April Wichman

NORTH DAKOTA

Bismark State College	Chandra Lundby Cameron Scott
Minot State University	Robert Brewer Laurie K. Hian Angela Luckman Chris Nett
North Dakota State University	Shanon Broden Brandon Higdem Martha Nettum Tracy Taszarek
University of North Dakota	Allen Blair Kimberly Blair Travis Maruska Heather Williams

SOUTH DAKOTA

Augustana College	Jenny Gors Sara Klimes Mike Smith Aaron Walters
South Dakota State University	Eric Boyd Addison Johnston
University of South Dakota	Timothy Baxter-Ferguson Lana Buss Doug Roegiers

REGION V PLAY ENTRIES

COLORADO

COLORADO STATE UNIVERSITY	<i>Once Upon a Mattress</i> <i>One Flew Over the Cuckoo's Nest</i>
FORT LEWIS COLLEGE	<i>No Exit</i>
MESA STATE COLLEGE	<i>A Midsummer Night's Dream</i>
WESTERN STATE COLLEGE	<i>Dear Brutus</i>

IOWA

BRIAR CLIFF COLLEGE	<i>Exit the King</i>
COE COLLEGE	<i>Assassins</i> <i>The Cherry Orchard</i>
CORNELL COLLEGE	<i>All the Way Home</i> <i>Good Night Desdemona, Good Morning Juliet</i>
DORDT COLLEGE	<i>The Chosen Daughter</i> <i>Peer Gynt</i> <i>Queens</i>
DRAKE UNIVERSITY	<i>All's Well That Ends Well</i>
GRINNELL COLLEGE	<i>Medieval Cycle Plays</i> <i>Vinegar Tom</i>
IOWA STATE UNIVERSITY	<i>Pirates of Penzance</i> <i>The Grapes of Wrath</i> <i>The Black Cross</i> <i>The Glass Menagerie</i> <i>The Miser</i>
NORTHWESTERN COLLEGE	<i>The Fantasticks</i> <i>The Reign of Fire</i> <i>Unspoken for Time</i>

SIMPSON COLLEGE

The Triumph of Love

ST. AMBROSE UNIVERSITY

A Streetcar Named Desire
The Glass Menagerie
Noises Off

UNIVERSITY OF IOWA

Out

UNIVERSITY OF NORTHERN IOWA

Assassins
Wild Honey

KANSAS

BUTLER COUNTY COMMUNITY COLLEGE

The Diviners

EMPORIA STATE UNIVERSITY

Blood Wedding
Guys and Dolls
House of Blue Leaves
Marvin's Room

FORT HAYS STATE UNIVERSITY

The Baby Dance

GARDEN CITY COMMUNITY COLLEGE

Joined at the Head

INDEPENDENCE COMMUNITY COLLEGE

The Tavern

JOHNSON COUNTY COMMUNITY COLLEGE

Othello, the Moor of Venice

KANSAS NEWMAN COLLEGE

Crimes of the Heart

KANSAS STATE UNIVERSITY

Chicago
Speed-the-Plow

OTTAWA UNIVERSITY

Come Back to the 5 and Dime, Jimmy Dean,
Jimmy Dean
Ghosts
The Victors

SOUTHWESTERN COLLEGE

The Glass Menagerie
Much Ado About Nothing

UNIVERSITY OF KANSAS

The Beadsmen
Canvass
Snakes
Tartuffe

WASHBURN UNIVERSITY

Moonchildren
Patient A

WICHITA STATE UNIVERSITY

Before It Hits Home
Tragedy Becomes Her
City of Angels

MINNESOTA

BEMIDJI STATE UNIVERSITY

Born Yesterday
The Tempest

MACALESTER COLLEGE

Goodnight Desdemona, Good Morning Juliet

MANKATO STATE UNIVERSITY

Antigone
Miller Mystery
South Pacific

MOORHEAD STATE UNIVERSITY

Chicago
Galileo
Picnic

SAINT MARY'S COLLEGE OF MINNESOTA

All for Love
Our Town
Rhinoceros

ST. CLOUD STATE UNIVERSITY

Lunacy
You Can't Take It With You

ST. OLAF'S COLLEGE

Pericles

UNIVERSITY OF MINNESOTA, DULUTH

The Baker's Wife
Dancing at Lughnasa

WILLMAR COMMUNITY COLLEGE

Man of La Mancha

WINONA STATE UNIVERSITY

The Medieval Plays

MISSOURI

AVILA COLLEGE

I Never Sang for My Father
The Importance of Being Earnest

COLLEGE OF THE OZARKS

Salt Lake City Skyline

FONTBONNE COLLEGE

Brilliant Traces
Vacant Space

LONGVIEW COMMUNITY COLLEGE

Cat on a Hot Tin Roof

NORTHEAST MISSOURI STATE UNIVERSITY

All My Sons
The Illusion

NORTHWEST MISSOURI STATE UNIVERSITY

Kennedy's Children
Macbeth

SOUTHEAST MISSOURI STATE UNIVERSITY

Heads Above Water, Heartblood in the Sand
Rumors
Zara Spook and Other Lures

SOUTHWEST MISSOURI STATE UNIVERSITY

Carousel
The Kathy and Mo Show: Parallel Lives
Measure for Measure
The Red House

ST. LOUIS COMMUNITY COLLEGE AT MERAMEC

Nice People Dancing to Good Country Music
The Night of the Iguana

WASHINGTON UNIVERSITY

Bad Blood
The Endless Adventures of M.C. Kat
The Seagull

WEBSTER UNIVERSITY

Jeffrey
Jo Nell Johnson and Ruthie Mapes
Nine

NEBRASKA

CHADRON STATE COLLEGE

Romeo and Juliet

CONCORDIA COLLEGE

A Doll's House

CREIGHTON UNIVERSITY

Les Liaisons Dangereuses

DOANE COLLEGE

Flow My Tears, the Policeman Said
The Marriage of Figaro
The Voice of the Prairie

NEBRASKA WESLEYAN UNIVERSITY

Good
You Never Can Tell

PERU STATE COLLEGE

The Musical Comedy Murders of 1940

UNIVERSITY OF NEBRASKA-KEARNEY

Antigone
The Importance of Being Earnest
The Wild Duck

UNIVERSITY OF NEBRASKA-LINCOLN

American Buffalo
Caucasian Chalk Circle
Crimes of the Heart
Heidi Chronicles
Scapino!

UNIVERSITY OF NEBRASKA-OMAHA

Mad Forest
Spokesong

NORTH DAKOTA

BISMARCK STATE COLLEGE

House of Blue Leaves

MINOT STATE UNIVERSITY

Mother Hicks
The Real Thing
Rumors
The Secret Garden

NORTH DAKOTA STATE UNIVERSITY

Arms and the Man
Blithe Spirit
On the Verge

UNIVERSITY OF NORTH DAKOTA

O Pioneers!
Saturday's Children

SOUTH DAKOTA

AUGUSTANA COLLEGE

Unspoken for Time
West Side Story

SOUTH DAKOTA STATE UNIVERSITY

The Elephant Man

UNIVERSITY OF SOUTH DAKOTA

Family Tree
Black Sheep
Redwood Curtain
Vinegar Tom

REGION V 1994 SCREENING TEAM

Bruce A. Bardwell	Fort Hays State University
Jim Bartruff	Moorhead State University
Barry R. Bengtson	Pittsburg State University
Gretta Berghammer	Univ. of Northern Iowa
David Blatt	Wichita State University
Bob Bradley	Southwest Missouri State U.
David Bratt	Winona State University
Carlyn Cahill	Fontbonne College
Joyce Cavarozzi	Wichita State University
Dennis Chandler	Univ. of South Dakota
Arlene Chapman	St. Louis Comm. College
Lori Dawson	Iowa State University
Marcia Joy Douglas	S.W. Missouri State U.
Jay Edelnant	Univ. of Northern Iowa
Paul Edwards	Western State College
Layne Ehlers	Univ. of Nebraska-Lincoln
Kristofer Eitrheim	St. Ambrose University
Darcy Engen	Univ. of Northern Iowa
Mark Frank	Coffeyville Comm. College
Ron Frederickson	Emporia State University
Pete Genovese	St. Louis C.C. at Meramec
Michael Gerlach	Mesa State College
Mark Giesler	Univ. of Nebraska-Lincoln
Charlene Gould	Avila College
Jim Greer	St. Louis Community College
Daniel Guyette	Univ. of Northern Colorado
Julie Hagemeyer	Univ. of Nebraska-Lincoln

Eric Hagen	University of South Dakota
Roy Hamlin	Cornell College
Kim Harris	William Jewell College
Gregg Henry	Iowa State University
Beth Hill	Maplewoods Comm. College
Paul J. Hustoles	Mankato State University
Corinne Johnson	St. Ambrose University
Kaarin Johnston	College of St. Benedict
Tisch Jones	University of Northern Iowa
Piet R. Knetsch	Wichita State University
Harry Langdon	Johnson Cnty Comm. College
Robert Larson	Luther College
John Lefler	Mankato State University
Paul Lifton	North Dakota State University
Paula Lindekugel-Willis	Minot State Univ.
Deborah J. Lotsof	Briar Cliff College
Shirley Carr Mason	U. of Nebraska-Lincoln
Allison Moon	Southwestern College
James Nicholson	Washington University
C. Ronald Olauson	Mankato State University
Julia Pachoud	Augustana College
Harry B. Parker	Emporia State University
Joyce Pauley	Moberly Area Comm. College
Larry Peters	Ottawa University
Bob Peterson	Butler County Comm. College
Beate Pettigrew	Johnson Cnty Comm. College
Robert R. Pevitts	St. Mary's College of Minn.
Cindy Phaneuf	Univ. of Nebraska-Omaha
Tim Pinnow	St. Olaf's College
Dan Plato	University of North Dakota

Paul Prece	Washburn University
Alexis Reising-Harris	KS Newman College
Kenn Robbins	University of South Dakota
Bill Robinson	Mesa State College
Kay Robinson	Bemidji State University
Daniel L. Rogers	Bismark State College
Jennifer S. Ross	Simpson College
Roberta N. Rude	University of South Dakota
Jim Ryan	Emporia State University
Paul Sannerud	Cornell College
Leigh Selting	University of Wyoming
Raymond L. Sikes	St. Louis Community College at Meramec
Norman E. Schroder	Bethany College
Don Schulte	Southeast Missouri State Univ.
Phil Speary	Butler County Comm. College
Theodore Swetz	Univ. of Missouri-Kansas City
Jim Wallace	Normandale Comm. College
Willis M. Watt	Fort Hays State University
Mira Wiegmann	Concordia College
David Wheeler	Moorhead State University
Lewis E. Whitlock III	Mankato State University
Tom Woltd	Doane College
Marita Woodruff	Webster University
Judith Zivanovic	Kansas State University

IT'S THE PITS
SMOKED FIX'NS
 Lincoln's Only Authentic
 Hickory Smoked Bar-B-Q Food

**Give Your Taste
 Buds A Treat**

**Pork, Beef, Chicken
 Turkey & Ham**

**Dinners, Sandwiches
 Party Orders &
 Catering**

DINE IN OR CARRY OUT
 — BEER & WINE COOLERS —
 466-1659 4947 Holdrege Mon.-Sun.
 11-10

 *The*
Caffe Caper
 Espresso Bar
 SERVING SPECIALTY COFFEES & GOURMET DESSERTS
 477-3949

245 N. 13th St. ■ Gunny's Bldg. ■ Lincoln, NE 68508

A PROTAGONISTS VIEW...

"I, save suffering, prefer the Stout."

To which we say...

"Right-O! Deliver yourself to Crane River and decide for yourself which of our tasty, fresh beers you prefer. Available in assorted flavors and weights (pounds are best) and complemented with fine pub fare and a friendly atmosphere. Stage presents welcome."



CRANE RIVER

Brewpub & Cafe

ELEVENTH & 'P' STREETS • MONDAY-SATURDAY 11AM-1AM • SUNDAY NOON-MIDNIGHT

Valentino's

With Your Student I.D., Receive
 A **10% DISCOUNT** On Any Purchase*

*Offer not valid with any other discounted item.
 Offer good Mon. and Wed. for dining room & take-out only.

East Campus Downtown
 3457 Holdrege • 467-3611 232 N. 13th • 475-1501

Good Thru May 19th, 1995

Huey's

**Fine Foods
 & SPIRITS**

- BIG screen T.V.
- Keno
- Pickle cards
- 2 Foosball tables
- 3 Dart machines

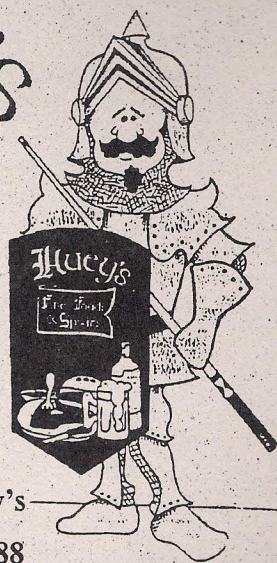

13th & Q
 Lower Level

Gunny's
 477-9888

Fine Arts

Nebraska Bookstore carries a wide selection of art and school supplies, books on art and artistry, dramas, plays and more...

National Championship Headquarters

**NEBRASKA
 BOOKSTORE**

1300 Q Street • 476-0111
 1-800-627-0047